

K46G
 Ser. No. 0000001-0009999
 Rev. 7-09-08

ACTUAL PARTS
 MAY NOT APPEAR
 AS SHOWN

NOTE:
 RESERVOIR TANK
 IS SUPPLIED BY
 VEHICLE MFG.

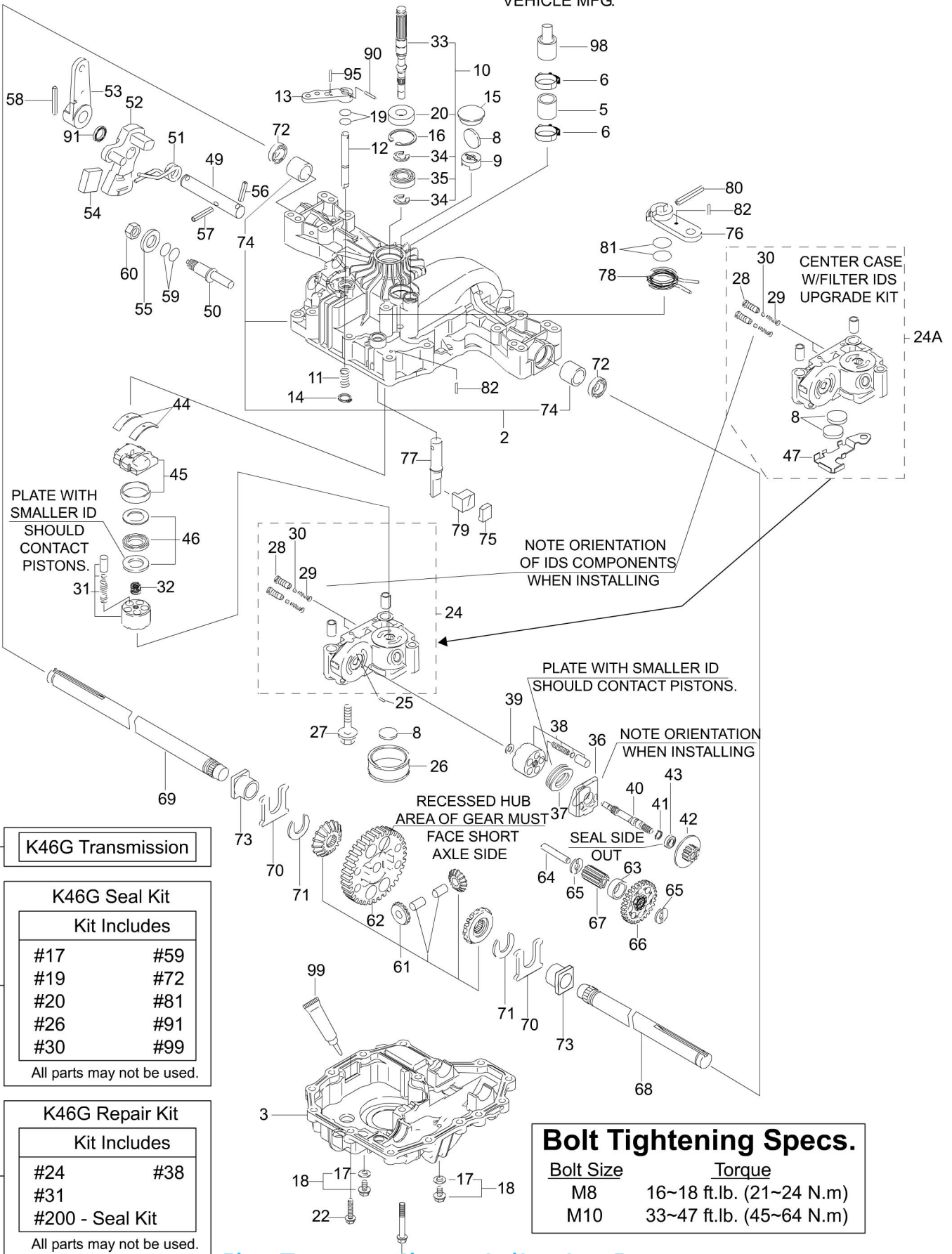

PLATE WITH
 SMALLER ID
 SHOULD
 CONTACT
 PISTONS.

NOTE ORIENTATION
 OF IDS COMPONENTS
 WHEN INSTALLING

PLATE WITH SMALLER ID
 SHOULD CONTACT PISTONS.

NOTE ORIENTATION
 WHEN INSTALLING

RECESSED HUB
 AREA OF GEAR MUST
 FACE SHORT
 AXLE SIDE

SEAL SIDE
 OUT

1- K46G Transmission

K46G Seal Kit

Kit Includes

- | | |
|-----|-----|
| #17 | #59 |
| #19 | #72 |
| #20 | #81 |
| #26 | #91 |
| #30 | #99 |

All parts may not be used.

K46G Repair Kit

Kit Includes

- | | |
|-----------------|-----|
| #24 | #38 |
| #31 | |
| #200 - Seal Kit | |

All parts may not be used.

Bolt Tightening Specs.

Bolt Size	Torque
M8	16~18 ft.lb. (21~24 N.m)
M10	33~47 ft.lb. (45~64 N.m)

ITEM No.	TUFF TORQ P/N	DESCRIPTION
	1115	5W50 SYNTHETIC OIL
24A	1A646099240	CENTER CASE W/FILTER SERV. KIT
1	7A646024060	K46G STI TRANSAXLE SN#1-014194
2	1A646099090	SERVICE KIT
3	1A646084163	LOWER CASE
5	1A646024280	TUBE
6	1A646024120	COBRA CLAMP
8	19216324360	MAGNET
9	1A646024370	MAGNET HOLDER
10	1A646099950	PUMP SHAFT/BEARING KIT
11	19215427281	SPRING 25
12	1A646029510	BYPASS SHAFT
13	1A632029520	BYPASS LEVER
14	19216829570	SNAP RING 10
15	1C655036300	SEALING CAP 30
16	22252000350	SNAP RING C 35
17	22190080000	SEAL WASHER 8
18	187Q0399940	DRAIN BOLT KIT
21	26476080552	TAPPING SCREW 8 * 55
22	26476080302	TAPPING SCREW 8 * 30
25	19216824760	PIN 3 * 9.8
26	168T2025220	FILTER 105
27	26106100752	BOLT 10 * 75
28	1A646024752	IDS VALVE
29	1A646024761	IDS SPRING
30	1A646024790	IDS FILTER 300
31	168T2025090	CYLINDER BLOCK (PUMP) KIT
32	1A646025200	SPRING
33	1A646025251	PUMP SHAFT, STANDARD
34	19215485310	E-RING 15
35	24101062020	BEARING 6202C3
36	19216824210	MOTOR HOUSING
37	1A646034750	THRUST BEARING 51106
38	168T2025100	CYLINDER BLOCK KIT (MOTOR)

39	19216825230	WASHER 12 * 24 * 1
40	1A646025271	MOTOR SHAFT
41	19215425310	SNAP RING S15
42	1A646085400	BRAKE DISC MOTOR GEAR (12T)
43	168T2025280	BEARING 6202
44	19216327051	THRUST METAL
45	168T2084530	SWASH PLATE CMP
46	19216399000	THRUST BEARING (PUMP) KIT
47	1A646029010	MAGNET HOLDER
49	1A646029664	CONTROL SHAFT
50	168T2029920	FULCRUM
51	1A646029730	TORSION SPRING-STANDARD
52	168T2029740	CONTROL ARM A
53	1A646089831	CONTROL LEVER
54	168T2029360	JERKY PLATE
55	22137120000	WASHER 12
56	22351060025	SPRING PIN 6 * 25
57	22351060036	SPRING PIN 6 * 36
58	22351060040	ROLL PIN 6 * 40
60	26776120002	NUT 12
61	1A646031570	DIFFERENTIAL GEAR KIT
62	1A646033520	FINAL GEAR (54T)
63	1A646033250	FINAL PINION COLLAR
64	1A646033410	REDUCTION SHAFT
65	19216833420	WASHER 12 * 32 * 3.2
66	1A646083450	REDUCTION GEAR (31T)
67	1A646033531	FINAL PINION GEAR (10T)
68	1A646084110	AXLE SHAFT LEFT
69	1A646084120	AXLE SHAFT, RIGHT
70	19216334261	THRUST WASHER
71	19216834270	RING 17
72	19216334280	SEAL 19 * 32 * 8
73	19216834350	BUSHING 19 * 25
74	168T2034240	BUSHING 19.05
75	1A646036121	BRAKE SHOE
76	1A646036160	BRAKE LEVER
77	1A646036171	BRAKE SHAFT
78	168T2036180	BRAKE RETURN SPRING

79	1A646036200	BRAKE ACTUATOR
80	22351050032	SPRING PIN 5 * 32
82	22351040016	SPRING PIN 4 * 16
83	1A646025300	SPLINE COLLAR
84	1A646025800	PULLEY F
85	1A646083050	FAN WHITE
86	1A646083060	WAVE WASHER
87	19215489090	SNAP RING
90	22351030020	SPRING PIN 3.0A * 20
95	22351030016	SPRING PIN 3.0A * 16
98	1A646024490	ADAPTER
99	1A646099500	SEALANT
102	1C656047570	COLLAR 17 * 30 * 3
200	1A646099140	SEAL KIT (K46 & T40)
201	1A646099590	REPAIR KIT K46 EXTENDED DESCRIP