

PowerG Spare Parts List

File: 0020100921AA

Version: 1.0

Petrol tiller ----TDS40A (Old model:TL40B1)

| Pos. No | Part code | Part name | QTY | losable | damage-able | Consum-able |
|---------|--------------|---|-----|---------|-------------|-------------|
| 1 | 921200 | pin & clip | 2 | Y | | |
| 2 | 921201R9005 | tiller assy | 2 | | | Y |
| 3 | B124009W014 | Hexagon head bolts M8x30 | 3 | | | |
| 4 | B500007W014 | Single coil spring lock washers 8 | 13 | | | |
| 5 | B501008W014 | Plain washers 8 | 13 | | | |
| 6 | B701403W014 | woodruff key 4x6.5x16 | 2 | | | |
| 7 | 921203R9005 | draw bar | 1 | | | Y |
| 8 | 921204 | pins& clamp spring | 1 | | | |
| 9 | 921900 | cable-belt tension | 1 | | | |
| 10 | 921300 | soft grip | 2 | | | |
| 11 | 921205R9005 | right handle bar | 1 | | | |
| 12 | 921206 | pin 6 | 1 | | | |
| 13 | 921004R3000 | control lever | 1 | | | |
| 14 | B400068FW014 | Cross recessed pan head tapping screws ST4.2x12 | 2 | | | |
| 15 | 921001R3000 | face plate | 1 | | | |
| 16 | 921207R9005 | left handle bar | 1 | | | |
| 17 | B217004W014 | Prevailing torque type hexagon nuts M6 | 11 | | | |
| 18 | B501007W014 | Plain washers 6 | 2 | | | |
| 19 | 921002R3000 | throttle lever | 1 | | | |
| 20 | B124006W014 | Hexagon head bolts M6x40 | 1 | | | |
| 21 | 921901 | cable-throttle control | 1 | | | |
| 22 | 921208 | washer 8.5x30x3 | 5 | | | |
| 23 | B124009W014 | Hexagon head bolts M8x30 | 6 | | | |
| 24 | B217005W014 | M8 | 9 | | | |
| 25 | B131002W014 | Hexagon flange bolts M6x16 | 1 | | | |
| 26 | 921209R3000 | handle bar support | 1 | | | |
| 27 | B124008W014 | Hexagon head bolts M8x20 | 6 | | | |
| 28 | 921902 | tie | 2 | | | |
| 29 | 921003 | tension pulley | 1 | | | |
| 30 | 921210 | sleeve | 1 | | | |
| 31 | 921211 | lever-tension pulley | 1 | | | |
| 32 | 921212 | pivot-pulley lever | 1 | | | |
| 33 | 921500 | spring-pulley lever | 1 | | | |
| 34 | 921213R3000 | guard | 1 | | | |
| 35 | 921501 | spring-wheel | 1 | | | |
| 36 | 921214 | pivot-wheel | 1 | | | |
| 37 | 921301 | wheel | 1 | | | Y |
| 38 | 921215 | washer 14.2x20x0.4 | 2 | | | |
| 39 | 921216R3000 | wheel arm | 1 | | | |

| | | | | | | |
|----|-------------|---|---|--|--|---|
| 40 | B501009W014 | Plain washers 10 | 1 | | | |
| 41 | B124011W014 | Hexagon head bolts M10x70 | 1 | | | |
| 42 | B217006W014 | Prevailing torque type hexagon nuts M10 | 2 | | | |
| 43 | 921217R3000 | main plate | 1 | | | |
| 44 | B131003W014 | Hexagon flange bolts M5x8 | 2 | | | |
| 45 | 921218R3000 | front cover | 1 | | | |
| 46 | 921219 | bolt 3/8-24UNFx25 | 1 | | | |
| 47 | B500008W014 | Single coil spring lock washers 10 | 1 | | | |
| 48 | 921220 | washer D10/30 | 2 | | | |
| 49 | 921221 | driving pulley | 1 | | | |
| 50 | 921222 | top plate | 2 | | | |
| 51 | 921223R9005 | engine plate | 1 | | | |
| 52 | 921224 | boss of driven pulley | 1 | | | |
| 53 | 921302 | "V"belt Z729 | 1 | | | Y |
| 54 | 921225 | driven pulley | 1 | | | |
| 55 | B131004W014 | Hexagon flange bolts M6x14 | 8 | | | |
| 56 | B131005W014 | Hexagon flange bolts M8x35 | 3 | | | |
| 57 | 00920ZA | engine assy | 1 | | | |
| 58 | 921903 | warning label | 1 | | | |
| 59 | 921904 | label-belt tension | 1 | | | |
| 60 | 921905 | label-throttle control | 1 | | | |
| 61 | 921100 | gear cases assy | 1 | | | |
| 80 | 921101 | gear cases sets | 1 | | | |
| 81 | 921907 | oil seal 20x32x6 | 3 | | | |
| 82 | B700464W014 | Deep groove ball bearing 6204-2RS | 1 | | | |
| 83 | 921226 | worm | 1 | | | |
| 84 | B700465W014 | Tapered roller bearing 30203 | 1 | | | |
| 85 | B700463W014 | Deep groove ball bearing 6004 | 2 | | | |
| 86 | B278018W014 | Circlips for shaft 20 | 2 | | | |
| 87 | 921227 | worm wheel | 1 | | | |
| 88 | 921906 | gasket-gear case | 1 | | | |
| 89 | 921228 | washer 10x16x1 -aluminium | 2 | | | |
| 90 | 921229 | bolt G1/8x8mm | 2 | | | |
| 91 | B217004W014 | Prevailing torque type hexagon nuts M6 | 8 | | | |
| 92 | B304038W014 | Hexagon socket head cap screws M6x38 | 2 | | | |
| 93 | B304037W014 | Hexagon socket head cap screws M6x28 | 6 | | | |
| 94 | 921230 | tiller shaft | 1 | | | |
| 95 | B701404W014 | woodruff key 5x7.5x19 | 1 | | | |
| 96 | 921231 | flat washer 20.5x35x0.3 | 2 | | | |
| 97 | B524006W014 | Serrated lock washers external teeth 6 | 8 | | | |
| 98 | 921232 | cover-oil seal | 2 | | | |

REMARKS:

1. The above quotations are based on RMB/USD=6.7280.
If RMB value increase over 5%, the prices should be adjustable.
- 2.If main material fluctuated more than 5%,the prices should be adjustable
3. Prices normally valid for one year from the day we offer,except the case we consider it invalid.
- 4.All prices should be subject to our final confirmation.

PowerG[®] EXPLOSIVE DRAWING

Petrol tiller ----TDS40A (Old model:TL40B1)

File: 0020100921AA

Version: 1.0

#BEZUG!

Model: TDS40&TDS40A

Apply to :

00921ZA(TDS40)

00921AA(TDS40A)

2010.4.21

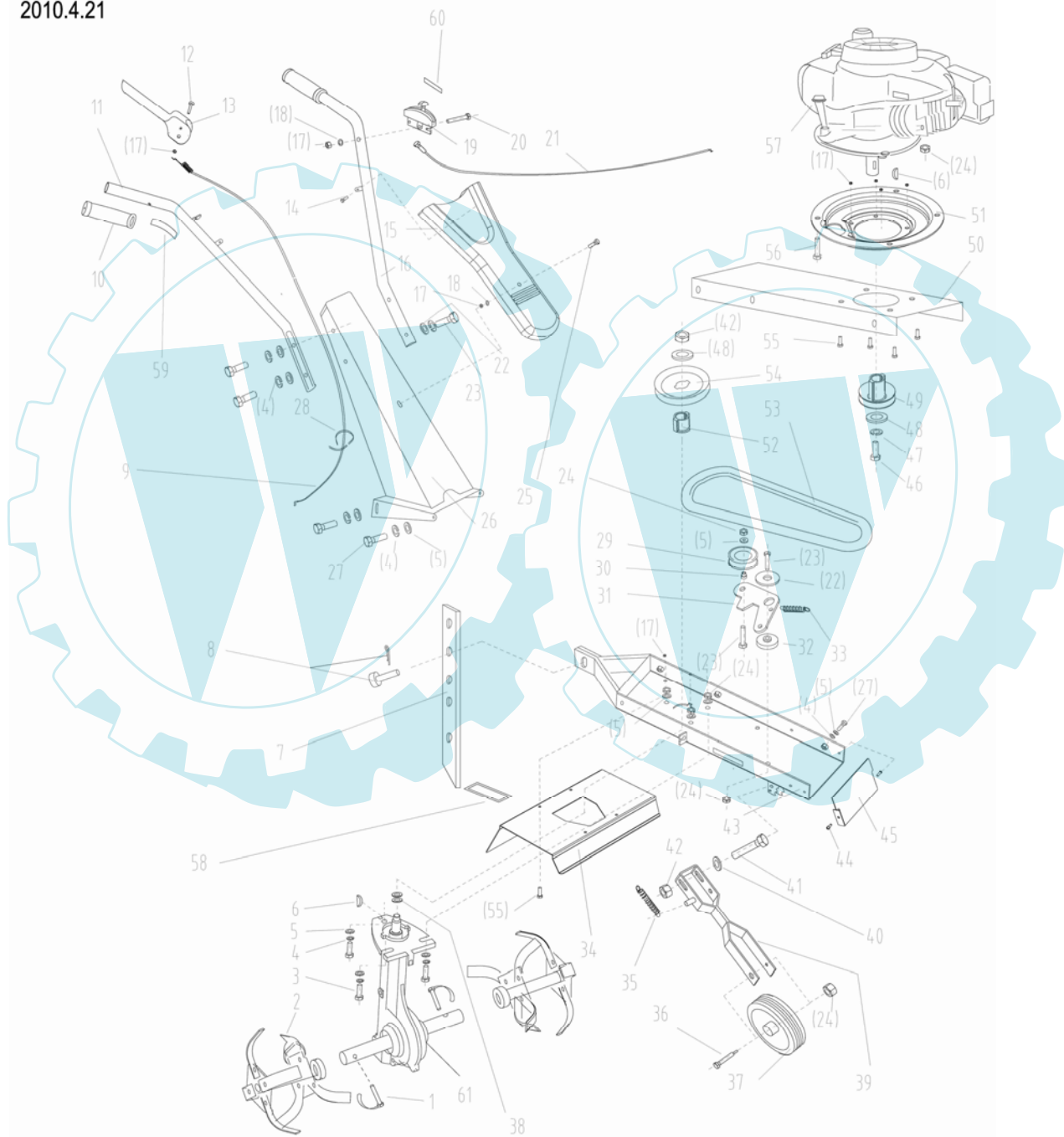

Model: TDS40&TDS40A

Apply to :

00921ZA(TDS40)

00921AA(TDS40A)

2010.4.21

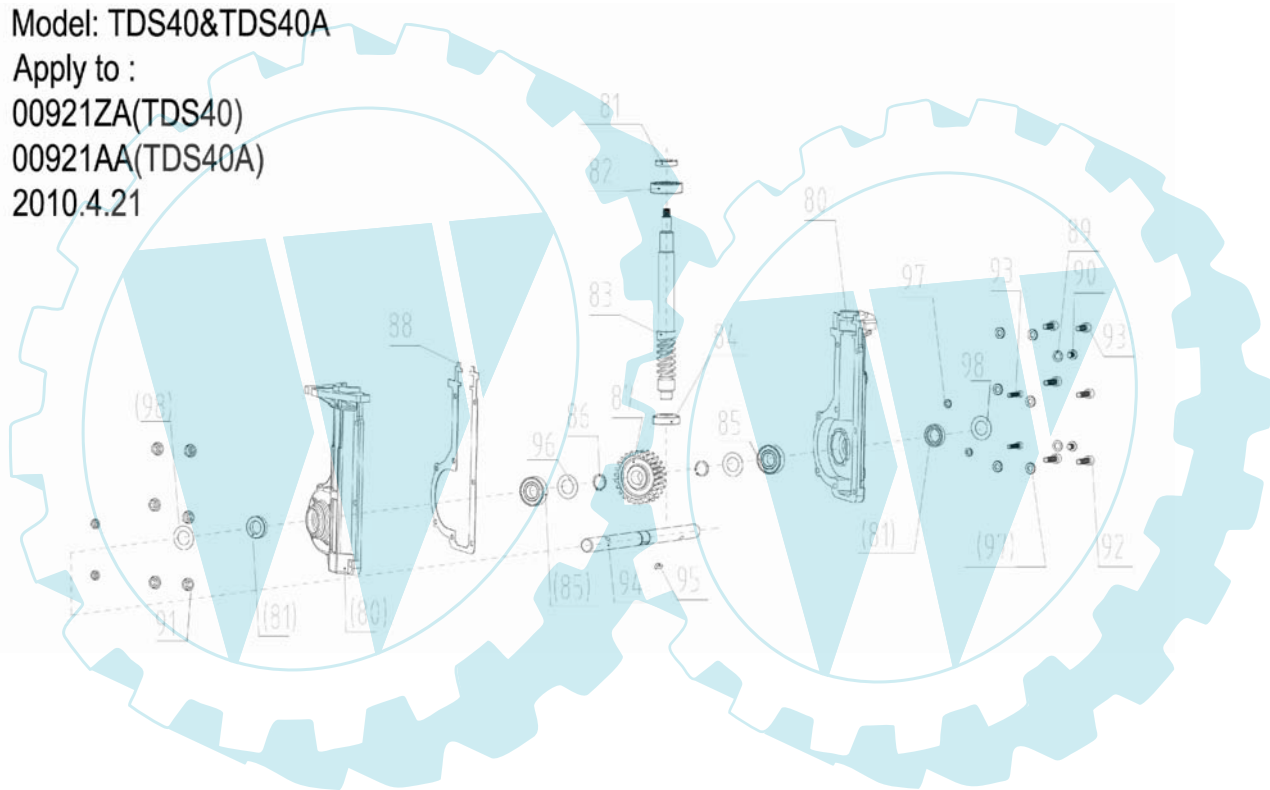



Spare Parts List

Engine-SP164FV(for TDS40A)

| Pos. No | Part code | Part Description | QTY | losable | damage-able | Consum-able | Remark |
|---------|-------------|---|-----|---------|-------------|-------------|--------|
| 1 | B400057W013 | Cross recessed pan head tapping screws ST3.9x19 | 3 | Y | | | |
| 2 | 920001 | exterior cover | 1 | | | | |
| 3 | 920002 | starter grip | 1 | | Y | | |
| 4 | B220008W013 | Hexagon nuts M6 | 5 | Y | | | |
| 5 | 920003 | starter cover | 1 | | | | |
| 6 | 920500 | volute spring | 1 | | | | |
| 7 | 920900 | starter rope | 1 | | | | |
| 8 | 920004 | starter pulley | 1 | | | | |
| 9 | 920501 | plate spring | 1 | | | | |
| 10 | 920200 | plate | 1 | | | | |
| 11 | 920201 | starting lever | 2 | | | | |
| 12 | 920245 | self-tapping screw | 1 | | | | |
| 13 | 920005 | fuel tank cap assy | 1 | | | | |
| 14 | 920300 | limit sets of fuel tank | 2 | Y | | | |
| 15 | 920006 | fuel tank | 1 | | | | |
| 16 | 920007 | fuel filter | 1 | | | | |
| 17 | 920202 | fuel pipe clip(Φ8.5) | 1 | Y | | | |
| 18 | 920301 | fuel pipe(305mm) | 1 | | | | |
| 19 | 920203 | fuel pipe clip(Φ7) | 1 | Y | | | |
| 20 | 920204 | tank fixed bush | 1 | | | | |
| 21 | 920302 | tank buffer sets | 1 | | | | |
| 22 | 920008 | fan housing | 1 | | Y | | |
| 23 | 920205 | bush | 3 | Y | | | |
| 24 | B229006W013 | Hexagon nuts with flange M14X1.5 | 1 | | | | |
| 25 | 920206 | starter bowl | 1 | | | | |
| 26 | 920009 | fan | 1 | | | | |
| 27 | 920207 | flywheel | 1 | | | | |
| 28 | 920700 | Ignition mouldle | 1 | | | | |
| 29 | B131010W013 | hexagon bolt with flang M6X20 | 1 | | | | |
| 30 | B174002W013 | Double end studs M6X80 | 3 | | | | |

| | | | | | | |
|----|-------------|--|---|---|---|--|
| 31 | 920303 | oil seal $\Phi 62 \times \Phi 25.4 \times 6$ | 1 | | | |
| 32 | 920100 | upper crankcase | 1 | | | |
| 33 | B131001W013 | hexagon bolt with flang M6X12 | 3 | Y | | |
| 34 | 920208 | windshield | 1 | | Y | |
| 35 | 920010 | valve | 1 | | | |
| 36 | 920901 | gasket | 1 | | | |
| 37 | 920011 | breath cover assy | 1 | | | |
| 38 | 920304 | breath tube | 1 | Y | | |
| 39 | B131002W013 | hexagon bolt with flang M6X16 | 6 | | | |
| 40 | 920101 | speed governor assy | 1 | | | |
| 41 | 920209 | pendulum | 1 | | | |
| 42 | B504006W013 | Plain washers 6 | 1 | Y | | |
| 43 | 920502 | circlip | 1 | | | |
| 44 | 920503 | rod spring | 1 | | Y | |
| 45 | 920210 | throttle lever | 1 | | | |
| 46 | B228001W013 | Hexagon nuts with flange M6 | 4 | Y | | |
| 47 | 920211 | square head bolts | 1 | | | |
| 48 | 920212 | rocker arm | 1 | | | |
| 49 | 920504 | governor spring | 1 | | | |
| 50 | B320015W013 | Pan head screws with cross recess M5X20 | 1 | Y | | |
| 51 | B131006W013 | hexagon bolt with flang M6X10 | 1 | Y | | |
| 52 | 920246 | stud bolt | 1 | | | |
| 53 | 920213 | cable limit | 1 | | | |
| 54 | 920214 | plate | 1 | | | |
| 55 | 920505 | compressed spring | 1 | | | |
| 56 | 920506 | rocker arm spring | 1 | | | |
| 57 | 920215 | control assy | 1 | | | |
| 58 | 920216 | damper with lever | 1 | | | |
| 59 | 920217 | piston ring sets1 | 1 | | | |
| 60 | 920218 | piston ring sets2 | 1 | | | |
| 61 | 920219 | scraper ring | 2 | | | |
| 62 | 920220 | expcmdr | 1 | | | |
| 63 | 920221 | piston | 1 | | | |
| 64 | 920222 | piston pin clip | 2 | | | |
| 65 | 920223 | crankshaft assy | 1 | | | |
| 66 | B701407W013 | woodruff key 4X5.5X25 | 1 | Y | | |
| 67 | 920102 | connecting rod | 1 | | | |
| 68 | B701406W013 | woodruff key 3 X3.7X10 | 1 | Y | | |
| 69 | 920224 | piston pin | 1 | | | |
| 70 | 920103 | driving gear | 1 | | | |
| 71 | 920225 | front ring | 1 | | | |
| 72 | B701651W013 | O-ring 2.15X16 | 1 | | | |
| 73 | 920012 | dip stick cover | 1 | | | |
| 74 | 920226 | locating pin $\Phi 8 \times 20$ | 2 | | | |
| 75 | 920104 | lower crankcase | 1 | | | |

| | | | | | | |
|-----|-------------|-----------------------------------|---|--|---|--|
| 76 | 920247 | hexagon bolt with flang M6X25 | 8 | | | |
| 77 | 920305 | oil seal Φ 41.3X Φ 28X6 | 1 | | | |
| 78 | 920227 | washer | 1 | | | |
| 79 | 920228 | oil drain bolt | 1 | | | |
| 80 | 920013 | air filter cover | 1 | | | |
| 81 | 920903 | air filter | 1 | | Y | |
| 82 | 920229 | pin set | 3 | | | |
| 83 | 920014 | air filter base | 1 | | | |
| 84 | 920904 | carburetor gasket | 2 | | | |
| 85 | 920230 | air filter fixed plate | 1 | | | |
| 86 | 920905 | carburetor LHP18 | 1 | | | |
| 87 | 920906 | heat shield gasket | 2 | | | |
| 88 | 920907 | insulation plate | 1 | | | |
| 89 | 920908 | connecting flange | 1 | | | |
| 90 | 920909 | flange gasket | 1 | | | |
| 91 | B174003W013 | Double end studs M6X94 | 2 | | | |
| 92 | 920910 | cylinder cushion | 1 | | | |
| 93 | 920231 | cylinder head cover | 1 | | | |
| 94 | 920911 | cylinder head cover | 1 | | | |
| 95 | B174001W013 | Double end studs M6X32 | 2 | | | |
| 96 | 920232 | locating pin Φ 10X15.7 | 2 | | | |
| 97 | 920105 | cylinder head assy | 1 | | | |
| 98 | 920701 | spark plug NHSP LD F7TL | 1 | | Y | |
| 99 | 920233 | intake valve | 1 | | | |
| 100 | B131012W013 | hexagon bolt with flang M8X65 | 4 | | | |
| 101 | 920234 | exhaust valve | 1 | | | |
| 102 | 920507 | valve spring | 2 | | | |
| 103 | 920235 | valve spring retainer | 2 | | | |
| 104 | 920306 | timing belt | 1 | | Y | |
| 105 | 920236 | curved rod | 1 | | | |
| 106 | 920237 | sleeve | 1 | | | |
| 107 | 920508 | decompression torsion spring | 1 | | | |
| 108 | 920106 | decompression block rejection | 1 | | | |
| 109 | 920015 | camshaft | 1 | | | |
| 110 | 920238 | intake rocker arm | 1 | | | |
| 111 | 920239 | rocker arm shaft | 2 | | | |
| 112 | 920240 | exhaust rocker arm | 1 | | | |
| 113 | 920241 | valve adjustment screw | 2 | | | |
| 114 | 920242 | valve adjustment nut | 2 | | | |
| 115 | 920243 | muffler | 1 | | | |
| 116 | 920244 | muffler guard | 1 | | | |

PowerG[®] **EXPLOSIVE DRAWING**

Petrol tiller ---Engine

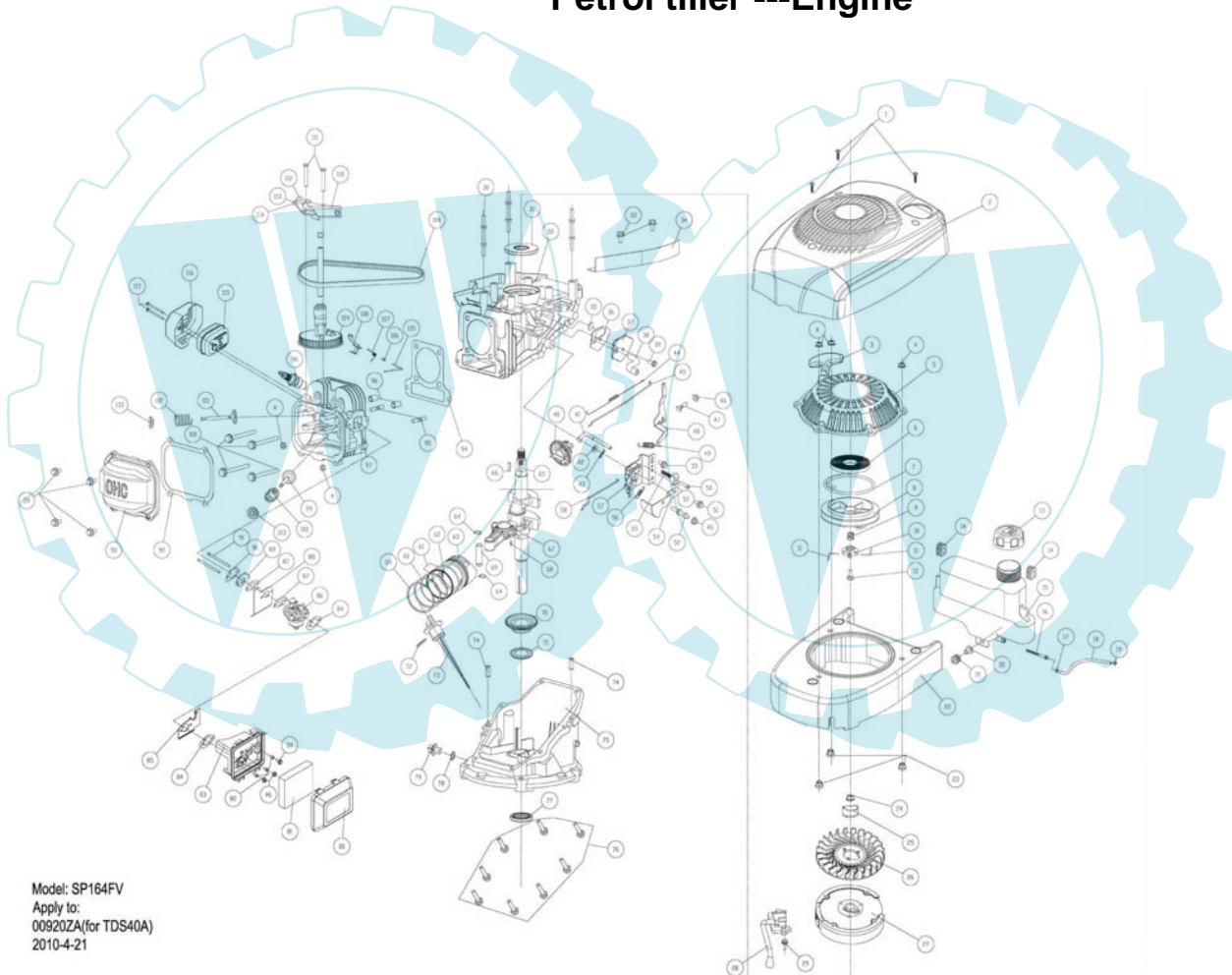

Model: SP164FV
Apply to:
00920ZA(for TDS40A)
2010-4-21

Ihr Ersatzteilspezialist im Internet