

# ZC-AHBB-3D5A-2CPX

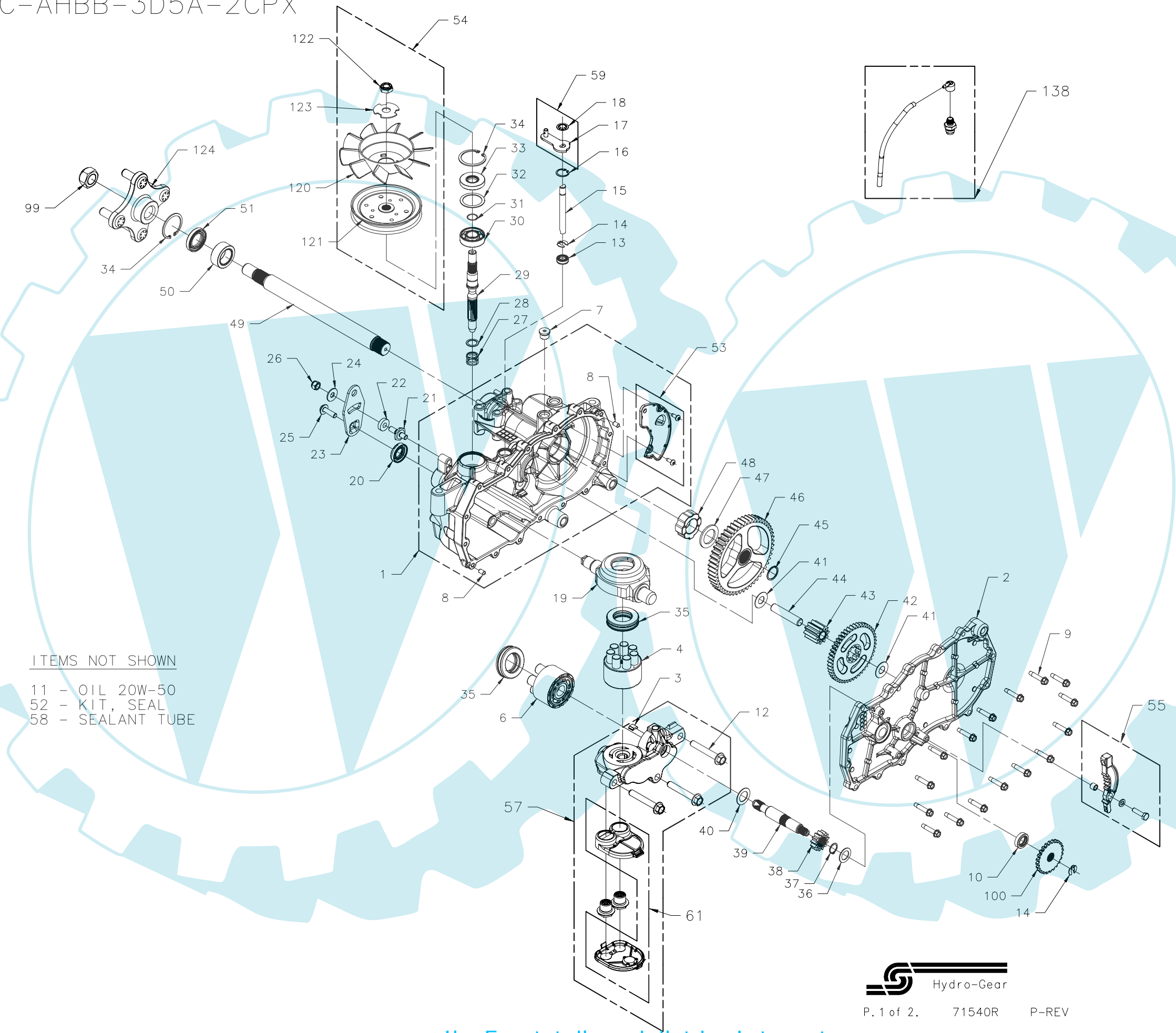

- ITEMS NOT SHOWN
- 11 - OIL 20W-50
  - 52 - KIT, SEAL
  - 58 - SEALANT TUBE



# ZC-AHBB-3D5A-2CPX

ITEM	PART #	QTY	DESCRIPTION
1	70862R	1	ASSEMBLY, MAIN HOUSING-RH HOUSING, MAIN RH-MACHINED BUSHING, .865 X .985 X .790 PLATE, EXPANSION RH SCREW, 10-32 X 1/2 (SELF-TAPPING) PIN, STANDARD, HEADLESS SEALANT TUBE, 10.3 oz SEAL, LIP .375 X .75 X .25
2	70863R	1	ASSEMBLY, SIDE-RH HOUSING, SIDE RH-MACHINED BUSHING, .624 X .719 X .562 BUSHING, .865 X .985 X .790
3	51448	1	PLATE, BYPASS
4	70723	1	ASSEMBLY, PUMP BLOCK (7P-10CC) BLOCK, CYLINDER PISTON SPRING, COMPRESSION WASHER, THRUST
6	70331	1	ASSEMBLY, MOTOR BLOCK (5P-10CC) BLOCK, CYLINDER PISTON SPRING, COMPRESSION WASHER, THRUST
7	9005110-5600	1	PLUG, SAE #6
8	9004800-2506	2	PIN, STAINLESS, HEADLESS
9	51190	16	HFHCS 1/4-20 X 1.25 (SELF-TAPPING)
10	70719	1	KIT, BRAKE SEAL
11		56 oz.	OIL, 20W-50
12	50016	3	BOLT, HEX FLANGE 3/8-24 X 2.5
13	51626	1	SEAL, LIP .375 X .75 X .25
14	51628	2	RING, RETAINING .375 EXT
15	51625	1	ROD, BYPASS
16	51627	1	RING, RETAINING .750 INT
17	51910	1	ARM, BYPASS
18	51630	1	RING, RETAINING .375 EXT (PUSHNUT)
19	51048	1	SWASHPLATE, TRUNNION, MACHINED
20	51140	1	SEAL, LIP 18 X 32 X 7
21	50426	1	STUD, SHORT 5/16-24
22	52298	1	PUCK, FRICTION
23	51631	1	ARM, CONTROL
24	44130	1	WASHER, FLAT 11/32 ID X 7/8 OD X 1/16
25	51812	1	TWHS 5/16-24 X 1.0
26	50317	1	NUT, HEX LOCK 5/16-24 UNJF
27	2003014	1	SPRING-HELICAL COMPRESSION
28	2003017	1	WASHER .591 X .787 X .040
29	51062	1	SHAFT, INPUT
30	50315	1	BEARING, BALL 17MM ID X 40MM OD X 12MM
31	2000022	1	RING, RETAINING WIRE .561 ID
32	50951	1	SPACER
33	51161	1	SEAL, LIP 17 X 40 X 7
34	50329	2	RING, RETAINING
35	50551	2	BEARING, THRUST 30 X 52 X 13
36	44371	1	WASHER, FLAT 5/8 ID X 1.0 OD X .05

ITEM	PART #	QTY	DESCRIPTION
37	44145	1	RING, RETAINING
38	51130	1	GEAR, PINION, 13T
39	51632	1	SHAFT, MOTOR
40	51069	1	WASHER, MOTOR SHAFT .71 ID X 1.16 OD X .04
41	50132	2	WASHER, HT .5 ID X 1.0 OD X .032
42	51129	1	GEAR, 10T/48T
43	51043	1	GEAR, 10T JACKSHAFT
44	51083	1	PIN, JACKSHAFT
45	52531	1	RING, SPIRAL RETAINING
46	52541	1	GEAR, 52T BULL
47	52532	1	WASHER, 1.018 X 1.57 X .105
48	52542	1	BEARING, SLEEVE (INBOARD)
49	52528	1	SHAFT, AXLE
50	51517	1	BUSHING, AXLE
51	51518	1	SEAL, LIP, 1.00 X 1.57 X .25
52	70853	1	KIT, SEAL
(10)			SEAL, LIP .625 X 1.000 X .250
(13)			SEAL, LIP .375 X .75 X .25
(20)			SEAL, LIP 18 X 32 X 7
(33)			SEAL, LIP 17 X 40 X 7
(51)			SEAL, LIP .750 X 1.577 X .250
(51)			SEAL, LIP 1.00 X 1.577
(10)			SEAL, LIP .50 X .88 X .25
(18)			RING, RETAINING .375 EXT
(16)			RING, RETAINING .750 INT
(14)			RING, RETAINING .375 EXT
(34)			RING, RETAINING 1.56 INT
(31)			RING, RETAINING WIRE .561
(37)			RING, RETAINING .62 EXT
(90)			RING, RETAINING, SPIRAL
53	70868R	1	KIT, EXPANSION PLATE, RH PLATE, EXPANSION RH SCREW, 10-32 X 1/2 (SELF-TAPPING)
54	70583	1	KIT, FAN-PULLEY FAN, 6", 10 BLADE PULLEY, 4.5" HEX LOCK NUT, 1/2-20 (NYLON INSERT) WASHER, OD SLOTTED .53 X 1.63 X .06
55	70865	1	KIT, BRAKE ARM ARM, PARKING BRAKE WASHER .28 X .50 X .063 BOLT, 1/4-20 X 1 W/PATCH BUSHING, .260 X .394 X .330
57	71530	1	KIT, CENTER SECTION-FILTER RH CENTER SECTION, RH-MACHINED PLATE, BYPASS BOLT, HEX FLANGE 3/8-24 X 2.5 FILTER, BASE CHECK PLUG ASSEMBLY .027, WASHER ASSEMBLY, COVER BUSHING, .707 X .788 X .591
58	50928	1	SEALANT TUBE, 10.3 oz

ITEM	PART #	QTY	DESCRIPTION
59	71006	1	KIT, BYPASS ARM ARM, BYPASS RING, RETAINING .375 EXT (PUSHNUT)
61	70911	1	KIT, FILTER FILTER, BASE ASSEMBLY, COVER
99	51901	1	NUT, HEX 9/16-18
100	51635	1	DISC, COG BRAKE
112	50594	1	HOSE, .5 X 8.75
115	50590	1	PINCH CLAMP, SINGLE EAR
120	51362	1	FAN, 6", 10 BLADE
121	51182	1	PULLEY 4.5
122	51244	1	HEX LOCK NUT, 1/2-20 (NYLON INSERT)
123	51523	1	WASHER OD SLOTTED .53 X 1.63 X .06
124	70314	1	ASSEMBLY, HUB HUB STUD, 1/2-20 X 1.5 (RIBBED)
138	71510	1	KIT, ASSEMBLY BREATHER CAP, BARBED VENT FITTING, O-RING ASSEMBLY HOSE, EXPANSION TANK

