

K1132-11112
311-2000

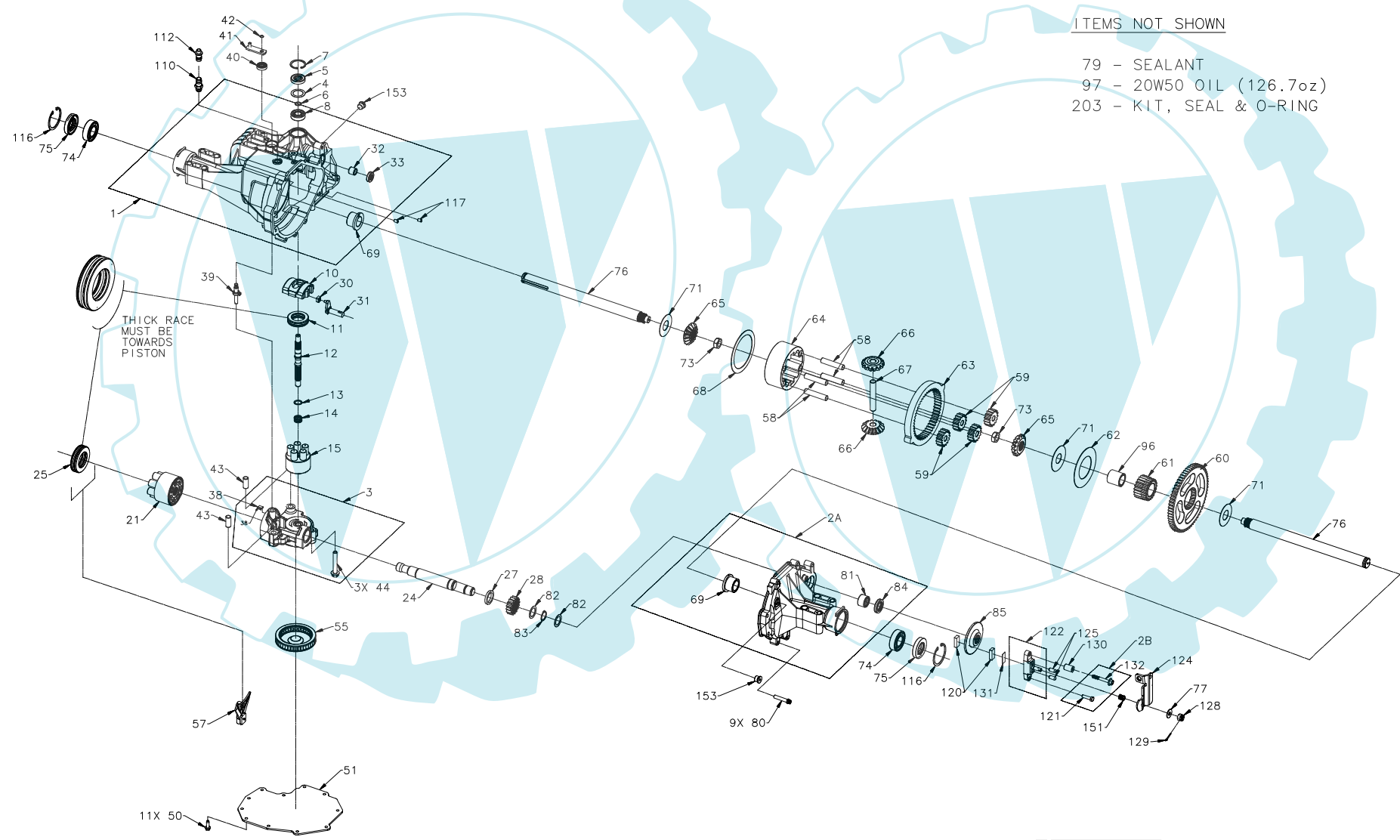

ITEMS NOT SHOWN

- 79 - SEALANT
- 97 - 20W50 OIL (126.7oz)
- 203 - KIT, SEAL & O-RING

THICK RACE
MUST BE
TOWARDS
PISTON



K1132-11112
311-2000

ITEM #	PART #	QTY	DESCRIPTION
1	70433	1	ASSEMBLY, MAIN HOUSING
		1	HOUSING, MAIN, CASE DRAIN
		1	SEAL, LIP 12 X 25 X 7
		1	BEARING, FLANGE 1.0 X 1.376 X .99
		1	BEARING, TRUNNION
		2	BEARING, CRADLE
2A	71120	1	ASSEMBLY, RIGHT HAND HOUSING
		1	HOUSING, RIGHT HAND
		1	BEARING, FLANGE 1.0 X 1.376 X .99
		1	BEARING, NEEDLE .875 X 1.125 X .75
		1	SEAL, LIP .875 X 1.375 X .250
2B	71139	1	KIT, BRAKE BOLT
		1	BOLT, HEX HD 1/4-20 X 1 W/PATCH
		1	BOLT, HEX HD 1/4-20 X 2 W/PATCH
3	70682	1	ASSEMBLY, CENTER SECTION
		1	CENTER SECTION
		1	BUSHING, .90 X 1.0 X .75
		1	PLATE, BYPASS
		2	CHECK PLUG ASSEMBLY, .027 BLEED
		3	SCREW, HEX FLANGE 3/8-24 X 2.5
4	2003018	1	SPACER, .98 X 1.37 X .04
5	9008000-0128	1	SEAL, LIP 15 X 35 X 7
6	2003016	1	RING, RETAINING
7	2003052	1	RING, RETAINING
8	2003043	1	BEARING, BALL .59 X 1.38 X .43
10	2003087	1	SWASHPLATE, VARIABLE
11	50551	1	BEARING, THRUST 30 X 52 X 13
12	50005	1	SHAFT, INPUT (NO CHARGE)
13	2003017	1	WASHER, THRUST .59 X .79 X .04
14	2003014	1	SPRING, BLOCK
15	70331	1	ASSEMBLY, BLOCK
		1	BLOCK, CYLINDER
		5	PISTON
		5	SPRING, COMPRESSION
		5	WASHER, THRUST
21	70082	1	ASSEMBLY, BLOCK
		1	BLOCK, CYLINDER
		7	PISTON
		7	SPRING, COMPRESSION
		7	WASHER, THRUST
24	50662	1	SHAFT, MOTOR
25	50552	1	BEARING, THRUST 42 X 68 X 16
27	50774	1	SPACER, 1.03 X 1.38 X .184
28	50661	1	GEAR, 16T PINION
30	2000015	1	GUIDE, SLOT
31	2003005	1	ARM, TRUNNION THRU HOLE
32	2003009	1	BEARING, TRUNNION
33	9008000-0126	1	SEAL, LIP 12 X 25 X 7
38	70680	1	KIT, BYPASS PLATE
39	2003555	1	ACTUATOR, BYPASS
40	45074	1	SEAL, LIP 10 X 25 X 7
41	50126	1	ARM, BYPASS
42	44870	1	RING, RETAINING
43	50002	2	PIN, HOLLOW .39 X .50 X 1.12
44	50016	3	SCREW, HEX FLANGE 3/8-24 X 2.5
50	50752	11	SCREW, HEX FLANGE 1/4-20 X .75
51	51128	1	COVER, LOWER W/O KIDNEYS
55	50990	1	FILTER, NO CHARGE
57	50796	1	RETAINER, MOTOR BEARING
58	50776	4	PIN, CARRIER
59	50763	4	GEAR, 15T PLANET
60	50646	1	GEAR, 67T SPUR
61	50645	1	GEAR, 21T SUN

ITEM #	PART #	QTY	DESCRIPTION
62	50769	1	WASHER, THRUST 2.32 X 4.10 X .05
63	50764	1	GEAR, 51T RING
64	50765	1	CARRIER, PLANETARY
65	50647	2	GEAR, 14T MITER (SPLINED)
66	50648	2	GEAR, 14T MITER (UNSPLINED)
67	50766	1	SHAFT, DIFFERENTIAL
68	50767	1	WASHER, THRUST 3.46 X 4.39 X .05
69	50768	2	BEARING, FLANGE 1.0 X 1.376 X .99
71	50788	3	WASHER, 1.0 X 2.25 X .04
73	50791	2	NUT, HEX 5/8-18 W/PATCH
74	50771	2	BEARING, BALL 25.4 X 52 X 15
75	50772	2	SEAL, LIP 1.0 X 2.049 X .375
76	50663	2	SHAFT, AXLE 1.0 X 13.80 (KEY)
77	44130	1	WASHER, .34 X .88 X .06
79	50928	10.1oz	SEALANT
80	50868	9	SCREW, TORX HD 5/16-18 X 1.5
81	44752	1	BEARING, NEEDLE .875 X 1.125 X .75
82	50777	2	WASHER, FLAT .88 X 1.25 X .04
83	50775	1	RING, RETAINING
84	50773	1	SEAL, LIP .875 X 1.375 X .250
85	50779	1	DISK, BRAKE
96	50866	1	BUSHING, SLEEVE 1.0 X 1.3 X 1.34
97		126.7oz	OIL, 20W50
110	70110	1	ASSEMBLY, FITTING O-RING
112	70109	1	ASSEMBLY, CAP-VENT
116	50859	2	RING, RETAINING
117	9004800-2506	2	PIN, STANDARD HEADLESS
120	44132	2	PUCK, BRAKE
121	44433	1	BOLT, HEX HD 1/4-20 X 1 W/PATCH
122	70633	1	ASSEMBLY, BRAKE YOKE
124	50911	1	ARM, BRAKE
125	44127	2	PIN, BRAKE ACTUATING
128	44142	1	NUT, CASTLE 5/16-24
129	44101	1	PIN, COTTER 3/32 X 3/4
130	23711	1	SPACER, .26 X .57 X .87
131	44134	1	PLATE, PUCK
132	51146	1	BOLT, HEX HD 1/4-20 X 2 W/PATCH
151	50919	1	SPRING, COMP. BRAKE ANTI-DRAG
153	9005110-5600	2	PLUG, 9/16-18 (METAL)
203	70492	1	KIT, SEAL & O-RING
		1	SEAL, LIP 15 X 35 X 7
		1	SEAL, LIP 12 X 25 X 7
		1	SEAL, LIP 10 X 25 X 7
		2	SEAL, LIP 1.0 X 2.049 X .375
		1	SEAL, LIP .875 X 1.375 X .250

