

788786  
313-2600R

80 - 20W-50 OIL  
100 - SEALANT  
134 - SEAL KIT

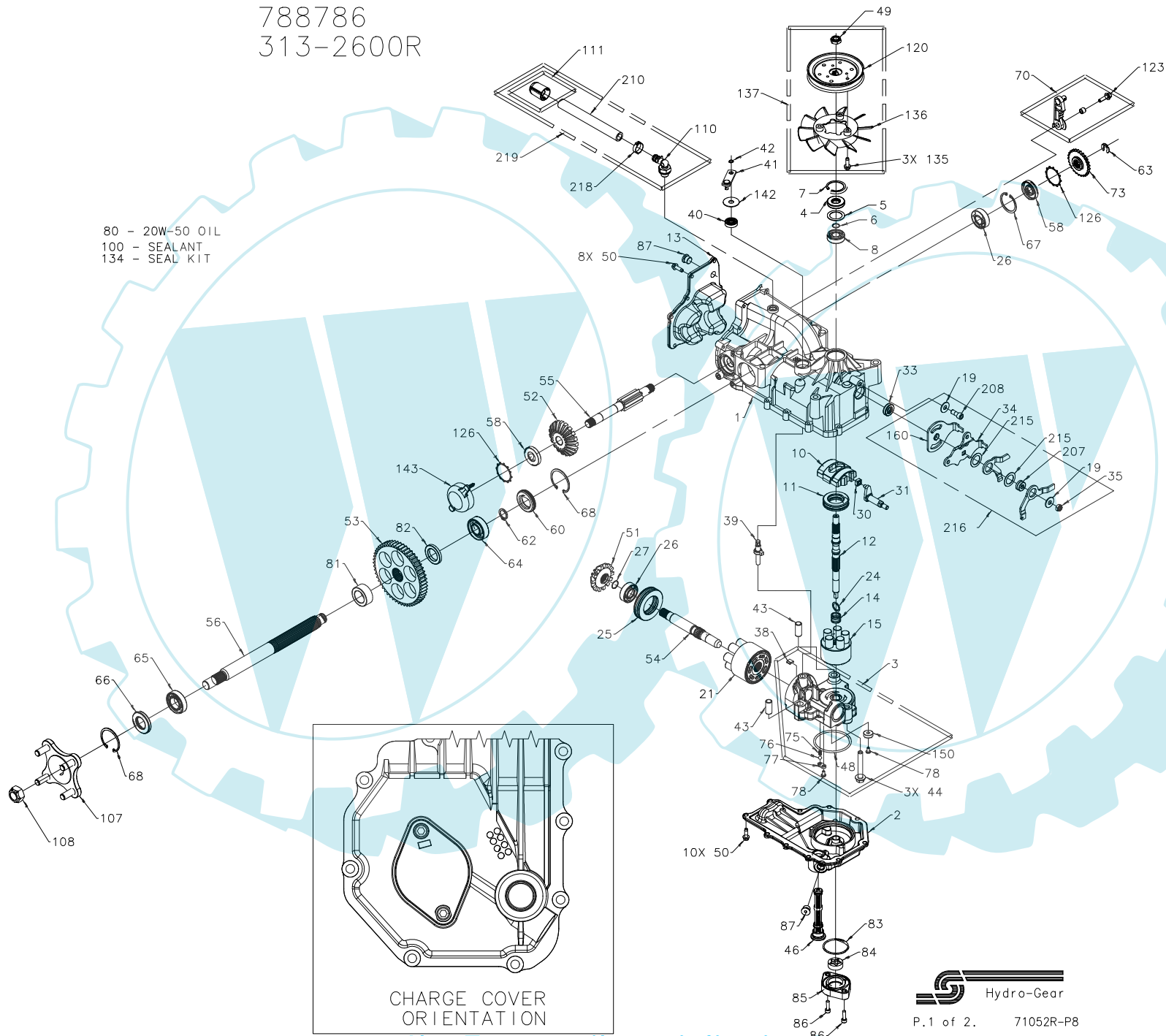

CHARGE COVER  
ORIENTATION

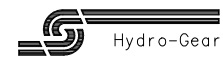

788786  
313-2600R

ITEM #	PART #	QTY	DESCRIPTION
1	70627	1	KIT, HOUSING-MAIN
		1	HOUSING, MAIN
		2	BEARING, CRADLE
		1	BUSHING, TRUNNION
		1	SEAL, LIP 12 X 25 X 7
		1	SCREW, HFHC 1/4-28 X 7/8 (PATCH)
2	51866	1	HOUSING, LOWER
3	70903	1	KIT, CENTER SECTION
		1	CENTER SECTION
		1	BUSHING .673 X 1.03 X .75
		1	PLATE, BYPASS
		3	HFHCS, 3/8-24 X 2.5 (PATCH)
		1	ASSEMBLY, SHOCK VALVE .027
		1	ASSEMBLY, SHOCK VALVE .044
		1	SPRING, CHARGE RELIEF
		1	BALL, 1/4
		1	O-RING, .139 X 2.984 X 7
		1	PLATE, RELIEF
		2	BOLT, SELF-TAPPING 10-32 X .5
		1	MAGNET, RING
		1	LIP SEAL
		1	SPACER
		1	WIRE RETAINING RING
		1	RETAINING RING
		1	BALL BEARING
		1	VARIABLE SWASHPLATE
		1	THRUST BEARING 30 X 52 X 13
		1	SHAFT, INPUT
		1	END COVER WITH DRAIN
		1	SPRING, BLOCK
		1	10cc CYLINDER BLOCK ASS'Y
		1	10cc CYLINDER BLOCK
		5	10cc PISTON SPRING
		5	PISTON SEAT WASHER
		5	10cc PISTON
19	44130	1	WASHER
21	70082	1	21cc CYLINDER BLOCK ASS'Y
		1	21cc CYLINDER BLOCK
		7	21cc PISTON SPRING
		7	PISTON SEAT WASHER
		7	21cc PISTON
		1	WASHER, BLOCK THRUST
24	2003017	1	THRUST BEARING 42 X 68 X 16
25	50552	1	BALL BEARING
26	50315	2	WIRE RETAINING RING
27	2000022	1	SLOT GUIDE
30	2000015	1	TRUNNION ARM
31	50807	1	LIP SEAL
33	9008000-0126	1	ARM, CONTROL
34	51394	1	NUT
35	50108	2	
38	70680	1	KIT, BYPASS PLATE
39	2003555	1	BYPASS ACTUATOR
40	45074	1	LIP SEAL
41	50270	1	BYPASS ARM
42	44870	1	RETAINING RING
43	50002	2	PIN
44	50016	3	SCREW
46	51931	1	ASSEMBLY, FILTER
49	51244	1	HEX LOCK NUT 1/2-20 (NYLON INSERT)
50	50752	18	SCREW, 1/4-20 X .75 LONG
51	50744	1	14T BEVEL GEAR
52	50745	1	19T BEVEL GEAR

ITEM #	PART #	QTY	DESCRIPTION
53	50746	1	53T SPUR GEAR
54	50757	1	MOTOR SHAFT
55	51298	1	BRAKE SHAFT
56	50748	1	AXLE SHAFT
58	51161	2	SEAL, LIP 17 X 40 X 7
60	50995	1	SEAL PLUG - SIDE
62	50759	1	RETAINING RING - AXLE
63	51109	1	RETAINING RING
64	50743	1	BEARING-BALL 20X47X14(6204)
65	50740	1	BEARING-BALL 25X47X12(6005)
66	50751	1	SEAL
67	50329	1	RETAINING RING
68	50760	2	RETAINING RING-AXLE
70	71088	1	RH, BRAKE ARM SERVICE ASSEMBLY
		1	BRAKE ARM
		1	CLEVIS PIN
		1	BUSHING .255 X .381 X .330
73	50754	1	SCREW, HFHC 1/4-20 X 7/8 (PATCH)
80		1	BRAKE DISC
81	51939	79oz	20W-50 OIL
82	51940	1	WASHER, AXLE 1.04 X 1.65 X .22
83	9004101-1340	1	WASHER, AXLE 1.04 X 1.65 X .70
84	50273	1	O-RING .103 X 1.862
85	50260	1	ASSEMBLY, GEROTOR
86	50095	1	COVER GEROTOR
87	9005110-5600	2	SHCS M6 X 20
100	50928	2	PLUG, 9/16-18 (METAL)
107	70314	1	SEALANT
		1	HUB ASSEMBLY
		1	HUB
		4	LUG BOLT
108	50863	1	NUT, HEX 3/4-16
110	51825	1	FITTING, 90° PLASTIC
111	70921	1	CAP-VENT ASSEMBLY
		1	CAP-POPPET VALVE
		1	ST .5 BARB VENT
120	52039	1	PULLEY, 4.50 INCH
123	51576	1	SCREW, HFHC 1/4-20 X 7/8 (PATCH)
126	51316	2	RING, RETAINING
134	70553	1	KIT, SEAL
		1	SEAL, LIP 15 X 35 X 7
		1	RING, RETAINING 37 INT
		1	SEAL, LIP 12 X 25 X 7
		1	SEAL, LIP 10 X 25 X 7
		1	RING, RETAINING .31 EXT
		18	HFHCS 1/4-20 X .75
		1	SEAL PLUG
		2	RING, RETAINING .75 EXT
		1	RING, RETAINING .440 EXT
		1	SEAL, LIP 25 X 47 X 7
		1	RING, RETAINING 1.56 INT
		2	RING, RETAINING 1.87 INT
		2	RING, RETAINING 1.43
		1	SCREW, SELF-TAPPING 1/4-20 X .75
135	50752	1	FAN, 6", 10 BLADE
136	51365	1	KIT, FAN-PULLEY
137	71140	3	SCREW, SELF-TAPPING 1/4-20 X .75
		1	FAN, 6", 10 BLADE
		1	HEX LOCK NUT 1/2-20 (NYLON INSERT)
		1	PULLEY, 4.50 INCH

ITEM #	PART #	QTY	DESCRIPTION
142	51813	1	WASHER .39 X 1.27 X .05
143	51774	1	CAP, BRAKE
150	51100	1	MAGNET, RING
160	51391	1	ARM, RETURN
207	51604	1	SPACER, RTN
208	51400	1	SHCS 5/16-24 X .75 (PATCH)
210	52040	2	HOSE Ø.50 X 6.50
215	51408	1	WASHER, PLASTIC 1.19 X .7
216	71326	1	KIT, RETURN
		2	WASHER
		1	CONTROL ARM
		1	HEX LOCK NUT, 5/16-24 INJF (NYLON INSERT)
		1	ARM, RTN SCISSOR, OUTER
		1	ARM, CW RTN SCISSOR, INNER
		1	ARM, RETURN
		1	SPACER, RTN
		2	SCREW, 5/16-24 X .74 (PATCH)
		1	WASHER, NYLON
		1	CLAMP, PINCH, SINGLE EAR 13/16
218	50590	1	KIT, BREATHER
219	71322	1	PINCH CLAMP, SINGLE EAR
		1	VENT, PLASTIC
		1	FITTING, 9/16 90°
		1	CAP, PLASTIC
		1	HOSE, Ø.50 X 6.50

