

618-0249
311-3000

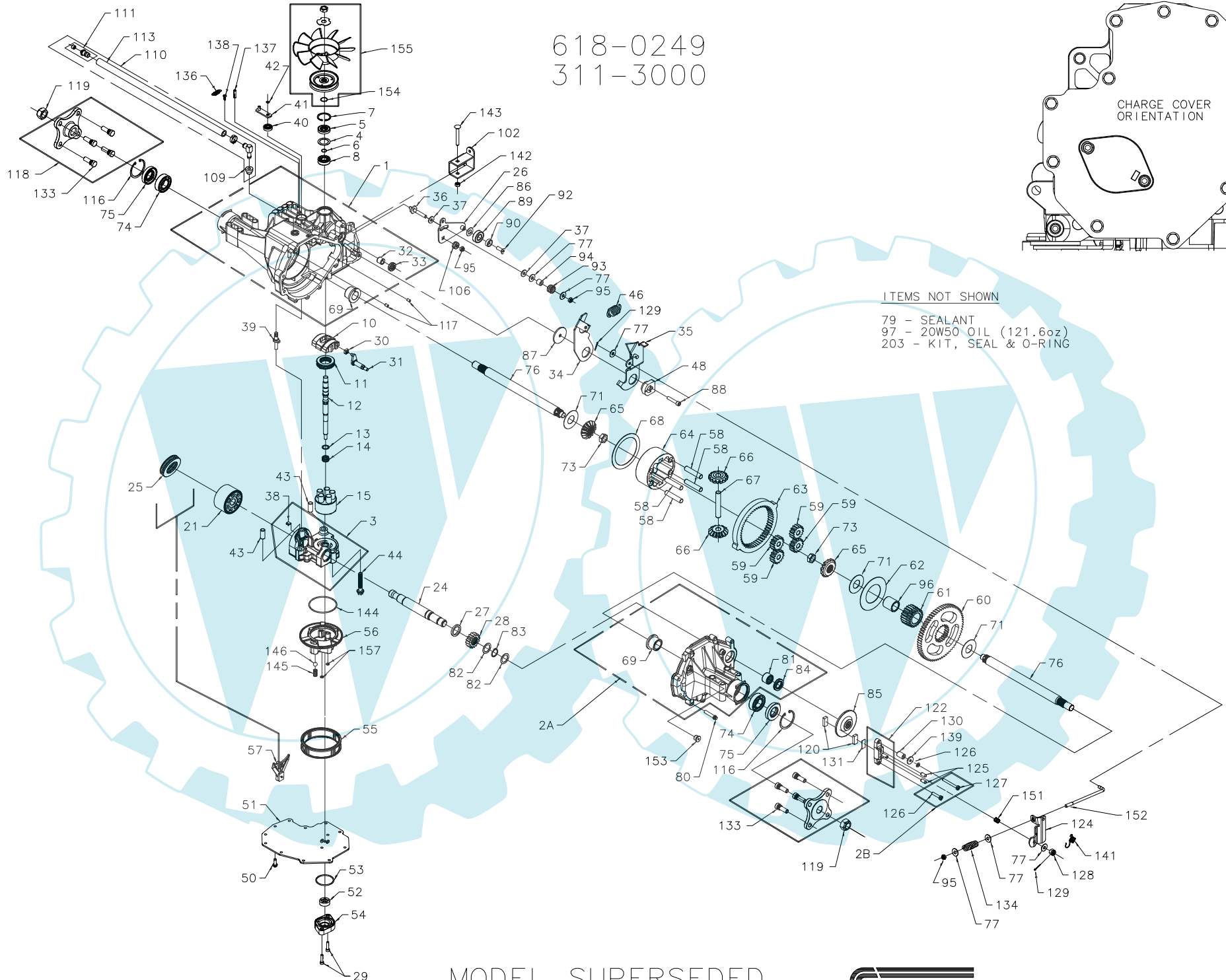
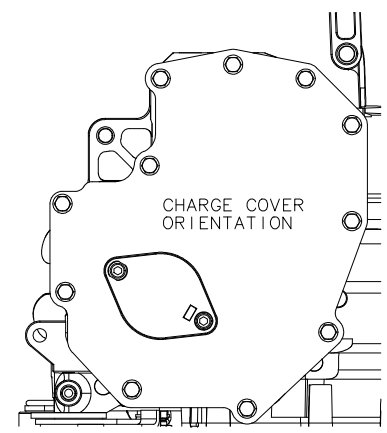

ITEMS NOT SHOWN

- 79 - SEALANT
- 97 - 20W50 OIL (121.6oz)
- 203 - KIT, SEAL & O-RING

MODEL SUPERSEDED

FOR ENTIRE MODEL REPLACEMENT
REFERENCE 618-0249A (324 3000)

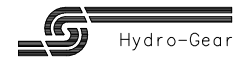

618-0249
311-3000

ITEM#	PART #	QTY	DESCRIPTION	ITEM#	PART #	QTY	DESCRIPTION	ITEM#	PART #	QTY	DESCRIPTION
1	70297	1	ASSEMBLY, MAIN HOUSING	43	50002	2	PIN, HOLLOW .39 X .50 X 1.12	110	70302	1	KIT, FITTING
		1	HOUSING, MAIN	44	50016	3	SCREW, HEX FLANGE 3/8-24 X 2.5			1	BUSHING, VENT (RUBBER)
		1	SEAL, LIP 12 X 25 X 7	46	50833	1	SPRING, 2.09 IN RETURN			1	ASSEMBLY, CAP-VENT
		1	BEARING, FLANGE 1.0 X 1.376 X .99	48	50835	1	PUCK, ADJUSTING			1	KIT, 90° FITTING & HOSE ASS'Y
		1	BEARING, TRUNNION	50	50752	11	SCREW, HEX FLANGE 1/4-20 X .75	111	70109	1	ASSEMBLY, CAP-VENT
		2	BEARING, CRADLE	51	50972	1	COVER, LOWER W/ 2 KIDNEYS			1	VENT, CAP
2A	71120	1	ASSEMBLY, RIGHT HAND HOUSING	52	50273	1	GEROTOR			1	VENT, PLASTIC
		1	HOUSING, RIGHT HAND	53	9004101-1340	1	O-RING, 1.862 X 2.068	113	70301	1	KIT, 90° FITTING & HOSE ASS'Y
		1	BEARING, FLANGE 1.0 X 1.376 X .99	54	50260	1	HOUSING, CHARGE PUMP			1	FITTING, 90° METAL VENT
		1	BEARING, NEEDLE .875 X 1.125 X 1.5	55	70538	1	KIT, FILTER			1	CLAMP, PINCH
		1	SEAL, LIP .875 X 1.375 X .250			2	GASKET, 4.24 X 4.40 X .10			1	HOSE, 0.5 X 20
2B	71139	1	KIT, BRAKE BOLT			1	FILTER, STD CHARGE	115	44133	1	NUT, HEX 1/2-20 W/ PATCH
		1	BOLT, HEX HD 1/4-20 X 1.25 W/PATCH	56	51156	1	MANIFOLD, CHARGE	116	50859	2	RING, RETAINING
		1	BOLT, HEX HD 1/4-20 X 2.25 W/PATCH	57	50796	1	RETAINER, MOTOR BEARING	117	9004800-2506	2	PIN, STANDARD HEADLESS
3	70683	1	ASSEMBLY, CENTER SECTION	58	50776	4	PIN, CARRIER	118	70276	2	ASSEMBLY, HUB
		1	CENTER SECTION	59	50763	4	GEAR, 15T PLANET			1	HUB, 4 STUD (PAINTED)
		1	BEARING, JOURNAL .50 X .59 X .50	60	50646	1	GEAR, 67T SPUR			4	STUD, 7/16-14 X 1.35 (RIB NECK)
		1	BEARING, .90 X 1.0 X .75	61	50645	1	GEAR, 21T SUN	119	50863	2	NUT, HEX LOCK 3/4-16
		1	PLATE, BYPASS	62	50769	1	WASHER, THRUST 2.32 X 4.10 X .05	120	44132	2	PUCK, BRAKE
		2	CHECK PLUG ASSEMBLY, .027 BLEED	63	50764	1	GEAR, 51T RING	121	51927	1	BOLT, HEX HD 1/4-20 X 1.25 W/PATCH
4	2003018	1	SPACER, .98 X 1.37 X .04	64	50765	1	CARRIER, PLANETARY	122	70633	1	ASSEMBLY, BRAKE YOKE
5	9008000-0128	1	SEAL, LIP 15 X 35 X 7	65	50647	2	GEAR, 14T MITER (SPLINED)	124	50911	1	ARM, BRAKE
6	2003016	1	RING, RETAINING	66	50648	2	GEAR, 14T MITER (UNSPLINED)	125	44127	2	PIN, BRAKE ACTUATING
7	2003052	1	RING, RETAINING	67	50766	1	SHAFT, DIFFERENTIAL	128	44142	1	NUT, CASTLE 5/16-24
8	2003043	1	BEARING, BALL .59 X 1.38 X .43	68	50767	1	WASHER, THRUST 3.46 X 4.39 X .05	129	44101	2	PIN, COTTER 3/32 X 3/4
10	2003087	1	SWASHPLATE, VARIABLE	69	50768	2	BEARING, FLANGE 1.0 X 1.376 X .99	130	23711	1	SPACER, .26 X .57 X .87
11	50551	1	BEARING, THRUST 30 X 52 X 13	71	50788	3	WASHER, 1.0 X 2.25 X .04	131	44134	1	PUCK, PLATE
12	50795	1	SHAFT, INPUT (STD CHARGE)	73	50791	2	NUT, HEX 5/8-18 W/ PATCH	132	51928	1	BOLT, HEX HD 1/4-20 X 2.25 W/PATCH
13	2003017	1	WASHER, THRUST .59 X .79 X .04	74	50771	2	BEARING, BALL 25.4 X 52 X 15	133	50869	8	STUD, 7/16-14 X 1.35 (RIB NECK)
14	2003014	1	SPRING, BLOCK	75	50772	2	SEAL, LIP 1.0 X 2.049 X .375	134	50915	1	SPRING, COMPRESSION BRAKE ANTI-DRAW
15	70331	1	ASSEMBLY, BLOCK	76	50825	2	SHAFT, AXLE 1.0 X 13.84 (30° SPLINED)	136	50384	1	SPRING, BYPASS 1.33 IN EXTENSION
		1	BLOCK, CYLINDER	77	44130	6	WASHER, .34 X .88 X .06	137	50882	1	PIN, SPRING .26 X 1
		5	PISTON	79	50928	10.1oz	SEALANT	138	50653	1	BOLT, SELF TAPPING 10-32 X .5
		5	SPRING, COMPRESSION	80	50868	9	SCREW, TORX HD 5/16-18 X 1.5	139	44278	1	WASHER, .27 X .88 X .12
		5	WASHER, THRUST	81	44752	1	BEARING, NEEDLE .875 X 1.125 X 1.5	141	50884	1	SPRING, BRAKE ARM BIAS
21	70082	1	ASSEMBLY, BLOCK	82	50777	2	WASHER, FLAT .88 X 1.25 X .04	142	43064	1	HEX LOCK NUT, 5/16-18
		1	BLOCK, CYLINDER	83	50775	1	RING, RETAINING	143	50886	1	BOLT, 5/16-18 X 2.5
		7	PISTON	84	50773	1	SEAL, LIP .875 X 1.375 X .250	144	50974	1	O-RING, 2.987 X 3.09
		7	SPRING, COMPRESSION	85	50779	1	DISK, BRAKE	145	51157	1	SPRING, RELIEF
		7	WASHER, THRUST	86	50132	1	WASHER, .51 X 1.0 X .03	146	9001214-4400	1	BALL, 7/16 IN
24	50662	1	SHAFT, MOTOR	87	50836	1	SPACER, .32 X 1.96 X .15	151	50919	1	SPRING, COMP. BRAKE ANTI-DRAW
25	50552	1	BEARING, THRUST 42 X 68 X 16	88	50837	1	SCREW, SOCKET HD CAP 5/16-24 X 1.5	152	50914	1	ROD, BRAKE PULL
26	50857	1	ARM, CONTROL	89	44147	1	BEARING, BALL .62 X 1.38 X .44	153	9005110-5600	1	PLUG, 9/16-18 (METAL)
27	50774	1	SPACER, 1.03 X 1.38 X .184	90	50839	1	SPACER, LOCATING	154	50920	1	RING, RETAINING
28	50661	1	GEAR, 16T PINION	92	50870	1	SCREW, COUNTERSUNK 5/16-18 X 1.0	155	70311	1	KIT, FAN/PULLEY
29	50975	2	SCREW, CAP M6 X 1 X 25	93	50277	1	SPRING, HELICAL COMP			1	NUT, HEX 1/2-20 W/ PATCH
30	2000015	1	GUIDE, SLOT	94	50278	1	SPACER, .587 X .319 X .500			1	WASHER, O.D SLOTTED .53 X 1.63 X .06
31	50807	1	ARM, TRUNNION TAPERED SQUARE	95	50108	3	NUT, HEX LOCK 5/16-24			1	FAN, 7.0 IN (10 BLADE)
32	2003009	1	BEARING, TRUNNION	96	50866	121.6oz	BUSHING, SLEEVE 1.0 X 1.3 X 1.34			1	PULLEY, 3.6 IN
33	9008000-0126	1	SEAL, LIP 12 X 25 X 7	97			OIL, 20W50			1	RING, RETAINING
34	50831	1	ARM, RETURN	102	50813	1	BRACKET, TORQUE	157	50977	2	O-RING, .239 X .309
35	50832	1	ARM, ACTUATING	103	50818	1	PULLEY, 3.6 IN	203	70492	1	KIT, SEAL & O-RING
36	50284	1	STUD, LONG 5/16-24	104	51862	1	FAN, 7.0 (10 BLADE)			1	SEAL, LIP 15 X 35 X 7
37	50281	2	PUCK, .798 X .319 X .097	106	51604	1	SPACER, TRUNNION			1	SEAL, LIP 12 X 25 X 7
38	70680	1	KIT, BYPASS PLATE	107	51523	1	WASHER, OD SLOTTED .53 X 1.63 X .06			1	SEAL, LIP 10 X 25 X 7
39	2003555	1	ACTUATOR, BYPASS	109	50133	1	BUSHING, VENT (RUBBER)			1	O-RING, 1.862 X 2.068
40	45074	1	SEAL, LIP 10 X 25 X 7							2	SEAL, LIP 1.0 X 2.049 X .375
41	50270	1	ARM, BYPASS							1	SEAL, LIP .875 X 1.375 X .250
42	44870	1	RING, RETAINING							4	O-RING, .239 X .309
										1	KIT, O-RING, MANIFOLD
										1	PIN, SPRING .26 X 1

MODEL SUPERSEDED
FOR ENTIRE MODEL REPLACEMENT
Im Ersatzteilspezialist im Internet
REPLACEMENT PARTS 618-0249 311-3000

