

3601CB  
347-2400L

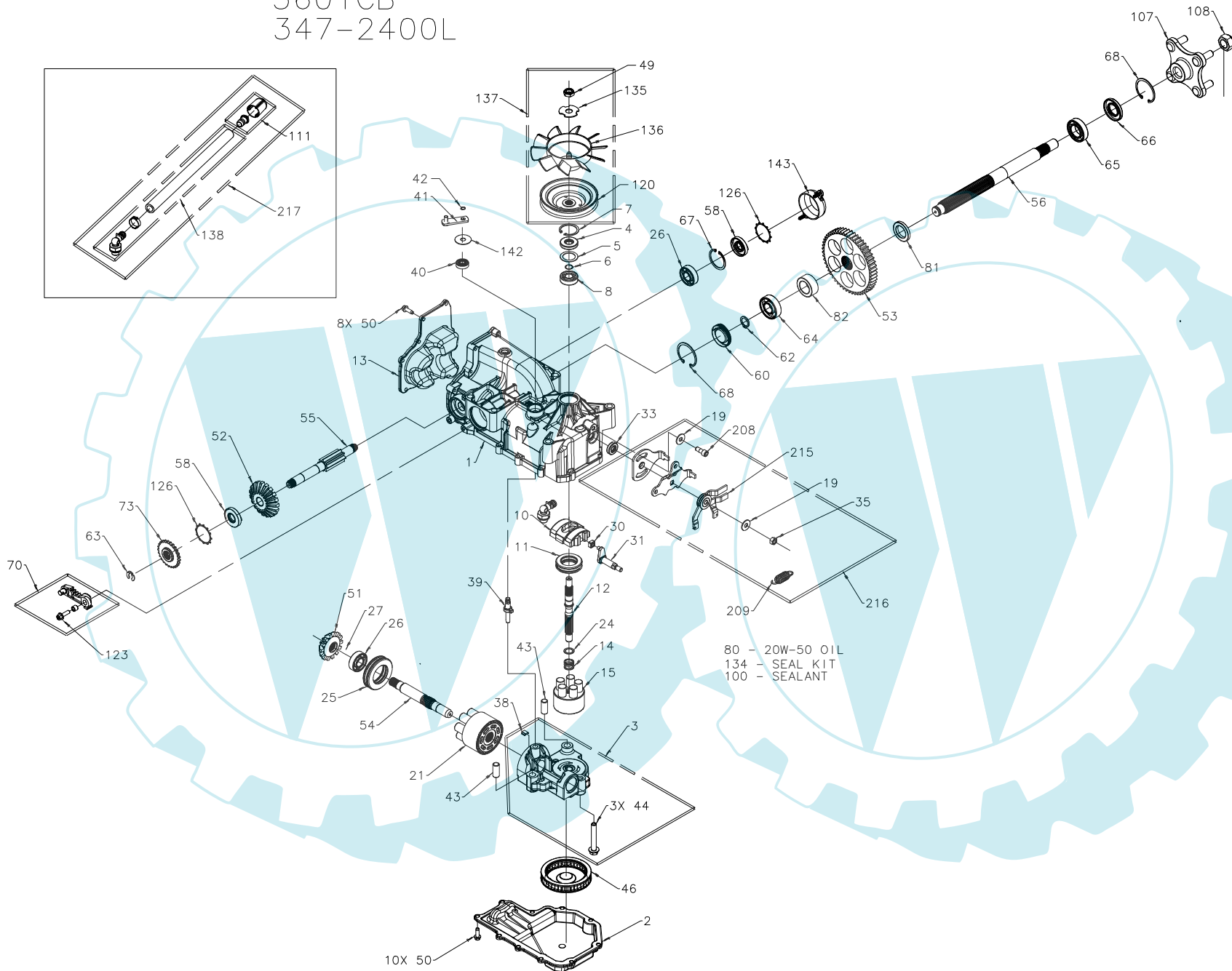

3601CB  
347-2400L

ITEM NO.	HYDRO-GEAR PART NO.	QTY.	DESCRIPTION	ITEM NO.	HYDRO-GEAR PART NO.	QTY.	DESCRIPTION	ITEM NO.	HYDRO-GEAR PART NO.	QTY.	DESCRIPTION
1	70627	1	KIT, HOUSING-MAIN	53	50746	1	53T SPUR GEAR	137	70600	1	KIT, FAN-PULLEY
		1	HOUSING, MAIN	54	50757	1	MOTOR SHAFT			1	WASHER, OD SLOTTED, .53 X 1.63 X .06
		2	CRADLE BEARING	55	51298	1	BRAKE SHAFT			1	FAN, 6", 10 BLADE
		1	LIP SEAL	56	50748	1	SHAFT, AXLE 1.0 X 12.3			1	HEX LOCK NUT 1/2-20 (NYLON INSERT)
		1	TRUNNION BUSHING	58	51161	2	SEAL, LIP 70 X 40 X 7			1	PULLEY, 4.5
2	50890RM	1	LOWER HOUSING	60	50995	1	SEAL PLUG - SIDE	138	70923	1	HOSE/FITTING ASSEMBLY
3	70679	1	KIT, CENTER SECTION	62	50759	1	RETAINING RING - AXLE			1	FITTING, 9/16, 90°
		1	CENTER SECTION	63	51109	1	RETAINING RING			1	PINCH CLAMP, SINGLE EAR
		1	BUSHING .67 X 1.03 X .75	64	50743	1	BEARING-BALL 20X47X14(6204)			1	HOSE, .5 X 12"
		1	PLATE, BYPASS	65	50740	1	BEARING-BALL 25X47X12(6005)	142	51813	1	WASHER, .39 X 1.27 X .05
		3	SCREW 3/8-24 X 2.5	66	50751	1	SEAL	143	51774	1	CAP, BRAKE
		2	CHECK PLUG ASSEMBLY, .044	67	50329	1	RETAINING RING	208	51400	1	SCREW, 5/16-24 X .75 (PATCH)
4	9008000-0128	1	LIP SEAL	68	50760	2	RETAINING RING-AXLE	209	52401	1	SPRING, EXTENSION
5	2003018	1	SPACER	70	70391	1	LH BRAKE ARM SERVICE ASSEMBLY	215	52411	1	ASSEMBLY, RTN
6	2003016	1	WIRE RETAINING RING			1	BRAKE ARM	216	70609	1	RTN, KIT
7	2003052	1	RETAINING RING			1	CLEVIS PIN			2	WASHER
8	2003043	1	BALL BEARING			1	BUSHING .255 X .381 X .330			1	NUT, LOCK, 5/16-24 UNF
10	2003087	1	VARIABLE SWASHPLATE			1	HEX WASHER HEAD SRCEW, 1/4-20 X 7/8			1	SCREW, 5/16-24 X .75 (PATCH)
11	50551	1	THRUST BEARING 30 X 52 X 13	73	50754	1	BRAKE, COG			1	SPRING, EXTENSION
12	50005	1	INPUT SHAFT	80		79oz	20W-50 OIL			1	CONTROL ARM
13	50891RM	1	COVER-BACK	81	51939	1	WASHER, AXLE 1.04 X 1.65 X .22			1	ARM, RETURN
14	2003014	1	SPRING, BLOCK	82	51940	1	WASHER, AXLE 1.04 X 1.65 X .70			1	ASSEMBLY, RTN
15	70331	1	10cc CYLINDER BLOCK ASS'Y	100	50928	1	SEALANT	217	70922	1	KIT, BREATHER ASSEMBLY
		1	10cc CYLINDER BLOCK	107	70314	1	HUB ASSEMBLY			1	HOSE/FITTING ASSEMBLY
		5	10cc PISTON SPRING			1	HUB			1	VENT CAP ASSEMBLY
		5	PISTON SEAT WASHER			4	BOLT, LUG				
		5	10cc PISTON	108	50863	1	NUT, HEX 3/4-16				
19	44130	2	WASHER	111	70921	1	CAP VENT ASSEMBLY				
21	70082	1	21cc CYLINDER BLOCK ASS'Y			1	CAP, PLASTIC				
		1	21cc CYLINDER BLOCK			1	VENT, PLASTIC				
		7	21cc PISTON SPRING	120	51363	1	PULLEY, 4.5				
		7	PISTON SEAT WASHER	123	51076	1	SCREW, HFHC 1/4-28 X 7/8 (PATCH)				
		7	21cc PISTON	126	51316	2	RING, RETAINING				
24	2003017	1	WASHER, BLOCK THRUST	134	70553	1	KIT, SEAL				
25	50552	1	THRUST BEARING 42 X 68 X 16			1	SEAL, LIP 15 X 35 X 7				
26	50315	2	BALL BEARING			1	RING, RETAINING				
27	2000022	1	WIRE RETAINING RING			1	SEAL, LIP 12 X 25 X 7				
30	2000015	1	SLOT GUIDE			1	SEAL, LIP 10 X 25 X 7				
31	50807	1	TRUNNION ARM			1	RING, RETAINING				
33	9008000-0126	1	LIP SEAL			2	SEAL, LIP 17 X 40 X 7				
35	52506	1	NUT, LOCK, 5/16-24 UNF			1	SEAL, LIP 1.85 X .32				
38	70680	1	KIT, BYPASS PLATE			1	RING, RETAINING				
39	2003555	1	BYPASS ACTUATOR			1	RING, RETAINING .440 EXTERNAL				
40	45074	1	LIP SEAL			1	SEAL, LIP .98 X 1.85 X .276				
41	50270	1	BYPASS ARM			1	RING, RETAINING				
42	44870	1	RETAINING RING			2	RING, RETAINING				
43	50002	2	PIN			2	RING, RETAINING				
44	50016	3	SCREW			2	SEAL, LIP 17 X 40 X 5				
46	50990	1	FILTER			1	WASHER, OD SLOTTED, .53 X 1.63 X .06				
49	51244	1	HEX LOCK NUT 1/2-20 (NYLON INSERT)	135	51523	1	FAN, 6", 10 BLADE				
50	50752	18	SCREW, 1/4-20 X .75 LONG	136	51364	1					
51	50744	1	14T BEVEL GEAR								
52	50745	1	19T BEVEL GEAR								



01/13/06 C. GOONAN

P5

ADDED NEW FRAME

REV'D ITEM 35, P/N 50108

TO P/N 52506

REMOVED ITEM 204, P/N 51393,

QTY 1, DESC ARM, RTN SCISSOR, OUTER

REMOVED ITEM 205, P/N 51392,

QTY 1, DESC ARM, RTN SCISSOR, INNER

REMOVED ITEM 207, P/N 51604,

QTY 1, DESC SPACER, RTN

REV'D ITEM 215, P/N 51408,

QTY 2, DESC WASHER, NYLON TO

P/N 52411, QTY 1, DESC ASSEMBLY, RTN

ECN #19694

09/28/06 R. GAGNON