

338-3000

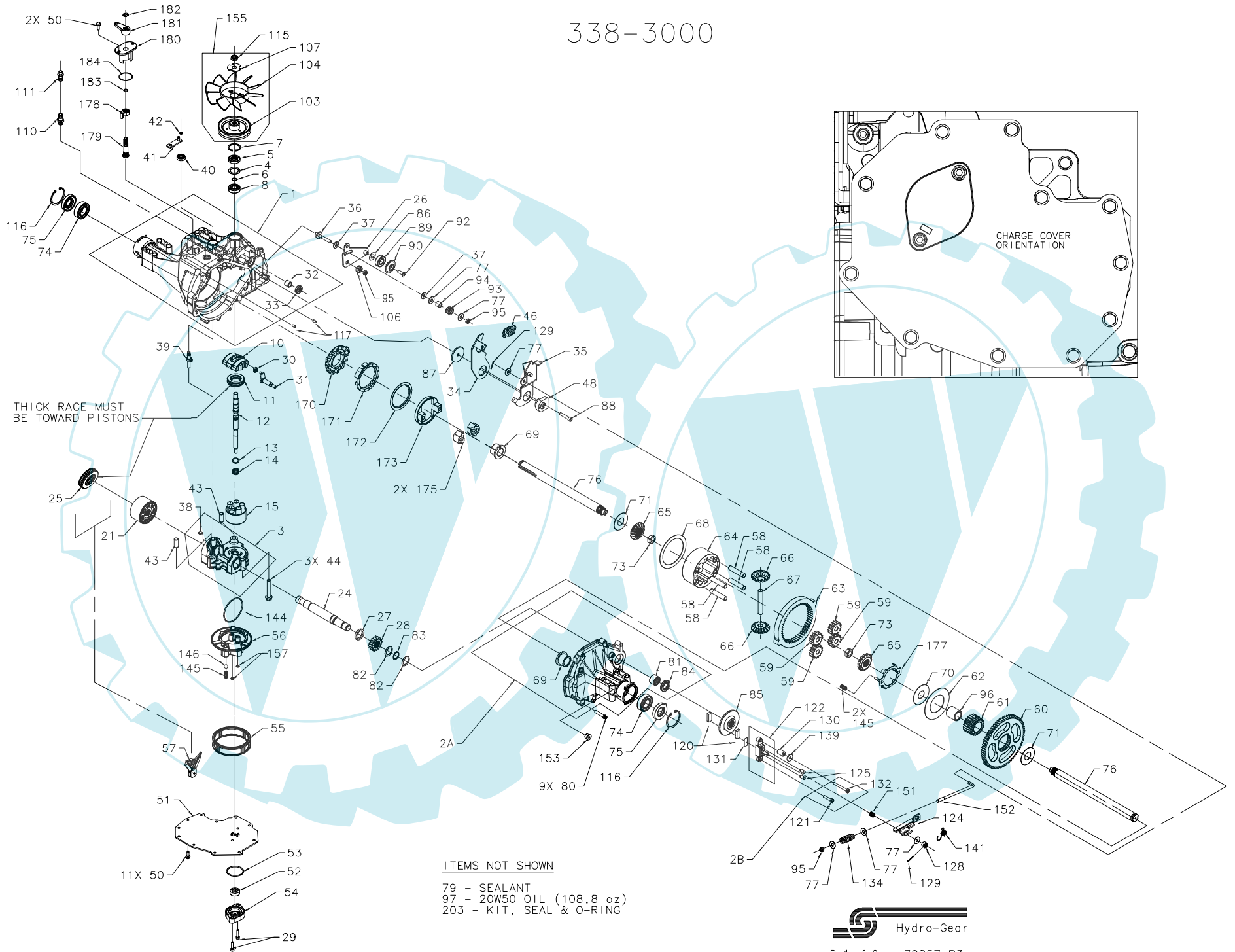

338-3000

ITEM#	PART #	QTY	DESCRIPTION	ITEM#	PART #	QTY	DESCRIPTION	ITEM#	PART #	QTY	DESCRIPTION
1	70875	1	ASSEMBLY, MAIN HOUSING	37	50281	2	PUCK, .798 X .319 X .097	106	51604	1	SPACER, TRUNNION
		1	HOUSING, MAIN, W/ DIFF LOCK	38	70680	1	KIT, BYPASS PLATE	107	51523	1	WASHER, OD SLOTTED .53 X 1.63 X .06
		1	SEAL, LIP 12 X 25 X 7	39	2003555	1	ACTUATOR, BYPASS	110	70110	1	ASSEMBLY, O-RING & FITTING
		1	BEARING, FLANGE 1.0 X 1.376 X .99	40	45074	1	SEAL, LIP 10 X 25 X 7			1	O-RING, .468 X .624
		1	BEARING, TRUNNION	41	50270	1	ARM, BYPASS			1	FITTING, PLASTIC STRAIGHT
		2	BEARING, CRADLE	42	44870	1	RING, RETAINING	111	70109	1	ASSEMBLY, CAPT-VENT
2A	71120	1	ASSEMBLY, RIGHT HAND HOUSING	43	50002	2	PIN, HOLLOW .39 X .50 X 1.12			1	CAP, VENT
		1	HOUSING, RIGHT HAND	44	50016	3	SCREW, HEX FLANGE 3/8-24 X 2.5			1	VENT, PLASTIC
		1	BEARING, FLANGE 1.0 X 1.376 X .99	46	50833	1	SPRING, 2.09 IN RETURN	115	51244	1	NUT, HEX LOCK 1/2-20 W/ NYLON INSERT
		1	BEARING, NEEDLE .875 X 1.125 X 1.5	48	50835	1	PUCK, ADJUSTING	116	50859	2	RING, RETAINING
		1	SEAL, LIP .875 X 1.375 X .250	50	50752	13	SCREW, HEX FLANGE 1/4-20 X .75	117	9004800-2506	2	PIN, STANDARD HEADLESS
2B	71139	1	KIT, BRAKE BOLT	51	50972	1	COVER, LOWER W/ 2 KIDNEYS	120	44132	2	PUCK, BRAKE
		1	BOLT, HEX HD 1/4-20 X 1.25 W/PATCH	52	50273	1	GEROTOR	121	51927	1	BOLT, HEX HD 1/4-20 X 1.25 W/PATCH
		1	BOLT, HEX HD 1/4-20 X 2.25 W/PATCH	53	9004101-1340	1	O-RING, 1.862 X 2.068	122	70633	1	ASSEMBLY, BRAKE YOKE
3	70684	1	ASSEMBLY, CENTER SECTION	54	50260	1	HOUSING, CHARGE PUMP	124	50911	1	ARM, BRAKE
		1	CENTER SECTION	55	70538	1	KIT, FILTER	125	44127	2	PIN, BRAKE ACTUATING
		1	BEARING, JOURNAL .50 X .59 X .50			2	GASKET, 4.24 X 4.40 X .10	128	44142	1	NUT, CASTLE 5/16-24
		1	BEARING, .90 X 1.0 X .75			1	FILTER, STD CHARGE	129	44101	2	PIN, COTTER 3/32 X 3/4
		1	PLATE, BYPASS			1	MANIFOLD, CHARGE	130	23711	1	SPACER, .26 X .57 X .87
		1	CHECK PLUG ASSEMBLY, .044 BLEED	56	51156	1	RETAINER, MOTOR BEARING	131	44134	1	PLATE, PUCK
		1	CHECK PLUG ASSEMBLY, NO BLEED	57	50796	1	PIN, CARRIER	132	51928	1	BOLT, HEX HD 1/4-20 X 2.25 W/PATCH
4	2003018	1	SPACER, .98 X 1.37 X .04	58	50776	4	GEAR, 15T PLANET	134	50915	1	SPRING, COMPRESSION BRAKE ANTI-DRAW
5	9008000-0128	1	SEAL, LIP 15 X 35 X 7	59	50763	1	GEAR, 67T SPUR	139	44278	1	WASHER, .27 X .88 X .12
6	2003016	1	RING, RETAINING	60	50646	1	GEAR, 21T SUN	141	50884	1	SPRING, BRAKE ARM BIAS
7	2003052	1	RING, RETAINING	61	50645	1	WASHER, THRUST 2.32 X 4.10 X .05	144	50974	1	O-RING, 2.987 X 3.09
8	2003043	1	BEARING, BALL .59 X 1.38 X .43	62	50769	1	GEAR, 51T RING	145	51157	3	SPRING, RELIEF
10	2003087	1	SWASHPLATE, VARIABLE	63	50764	1	CARRIER, PLANETARY	146	9001214-4400	1	BALL, 7/16 IN
11	50551	1	BEARING, THRUST 30 X 52 X 13	64	50765	1	GEAR, 14T MITER (SPLINED)	151	50919	1	SPRING, COMP. BRAKE ANTI-DRAW
12	50795	1	SHAFT, INPUT (STD CHARGE)	65	50647	2	GEAR, 14T MITER (UNSPLINED)	152	50914	1	ROD, BRAKE PULL
13	2003017	1	WASHER, THRUST .59 X .79 X .04	66	50648	2	SHAFT, DIFFERENTIAL	153	9005110-5600	1	PLUG, 9/16-18 (METAL)
14	2003014	1	SPRING, BLOCK	67	50766	1	WASHER, THRUST 3.46 X 4.39 X .05	155	70460	1	KIT, FAN/PULLEY
15	70331	1	ASSEMBLY, BLOCK	68	50767	1	BEARING, FLANGE 1.0 X 1.376 X .99			1	NUT, HEX LOCK 1/2-20 W/NYLON INSERT
		1	BLOCK, CYLINDER	69	50768	2	WASHER, 1.008 X 2.60 X .04			1	WASHER, O.D SLOTTED, .53 X 1.63 X .06
		5	PISTON	70	51642	1	WASHER, 1.0 X 2.25 X .04			1	FAN, 7.0 IN (10 BLADE)
		5	SPRING, COMPRESSION	71	50788	2	NUT, HEX 5/8-18 W/ PATCH	157	50977	2	PULLEY, 3.86 IN
		5	WASHER, THRUST	73	50791	2	BEARING, BALL 25.4 X 52 X 15	170	51644	1	O-RING, .239 X .379
21	70082	1	ASSEMBLY, BLOCK	74	50771	2	SEAL, LIP 1.0 X 2.049 X .375	171	51645	1	CAM, STATIONARY
		1	BLOCK, CYLINDER	75	50772	2	SHAFT, AXLE, 1 X 13.80 (KEY)	172	51646	1	CAM, ROTATING
		7	PISTON	76	50663	2	WASHER, .34 X .88 X .06	172	51646	1	WASHER, THRUST 2.78 X 3.60 X .036
		7	SPRING, COMPRESSION	77	44130	6	SEALANT	173	51647	1	PLATE, LOAD
		7	WASHER, THRUST	79	50928	10.1oz	SCREW, TORX HD 5/16-18 X 1.5	175	51648	2	DOG, ENGAGEMENT
24	50662	1	SHAFT, MOTOR	80	50868	9	BEARING, NEEDLE .875 X 1.125 X .75	177	51649	1	PLATE, GUIDE
25	50552	1	BEARING, THRUST 42 X 68 X 16	81	44752	1	WASHER, FLAT .88 X 1.25 X .04	178	51650	1	CAM, DIFF LOCK ACTUATING
26	50857	1	ARM, CONTROL	82	50777	2	RING, RETAINING	179	51651	1	SHAFT, DIFF LOCK ACTUATING
27	50774	1	SPACER, 1.03 X 1.38 X .184	83	50775	1	SEAL, LIP .875 X 1.375 X .250	180	51613	1	SLEEVE, DIFF LOCK ACTUATING
28	50661	1	GEAR, 16T PINION	84	50773	1	DISK, BRAKE	181	51652	1	ARM, DIFF LOCK ACTUATING
29	50975	2	SCREW, CAP M6 X 1 X 25	85	50779	1	WASHER, .51 X 1.0 X .03	182	51628	1	RING, RETAINING
30	2000015	1	GUIDE, SLOT	86	50132	1	SPACER .32 X 1.96 X .15	183	9004101-0120	1	O-RING, .364 X .504
31	50807	1	ARM, TRUNNION TAPERED SQUARE	87	50836	1	SCREW, HEX CAP 5/16-24 X 1.5	184	51654	1	O-RING, 1.489 X 1.629
32	2003009	1	BEARING, TRUNNION	88	50837	1	BEARING, BALL .62 X 1.38 X .44	203	70492	1	KIT, SEAL & O-RING
33	9008000-0126	1	SEAL, LIP 12 X 25 X 7	89	44147	1	SPACER, LOCATING			1	SEAL, LIP 15 X 35 X 7
34	50831	1	ARM, RETURN	90	51200	1	SCREW, COUNTERSUNK 5/16-18 X 1.0			1	SEAL, LIP 12 X 25 X 7
35	51512	1	ARM, ACTUATING	92	50870	1	SPRING, HELICAL COMP.			1	SEAL, LIP 10 X 25 X 7
36	50284	1	STUD, LONG 5/16-24	93	50277	1	SPACER, .587 X .319 X .500			1	O-RING, 1.862 X 2.068
				94	50278	1	NUT, HEX LOCK 5/16-24			2	SEAL, LIP 1.0 X 2.049 X .376
				95	50108	3	BUSHING, SLEEVE 1.0 X 1.3 X 1.34			4	SEAL, LIP .875 X 1.375 X .250
				96	50866	1	OIL, 20W50			1	O-RING, .239 X .309
				97		108.8oz	PULLEY, 3.86 IN			1	KIT, O-RING, MANIFOLD
				103	51231	1	FAN, 7.0 IN (10 BLADE)			1	O-RING .364 X .504
				104	51230	1				1	O-RING 1.489 X 1.629

