

319-3500

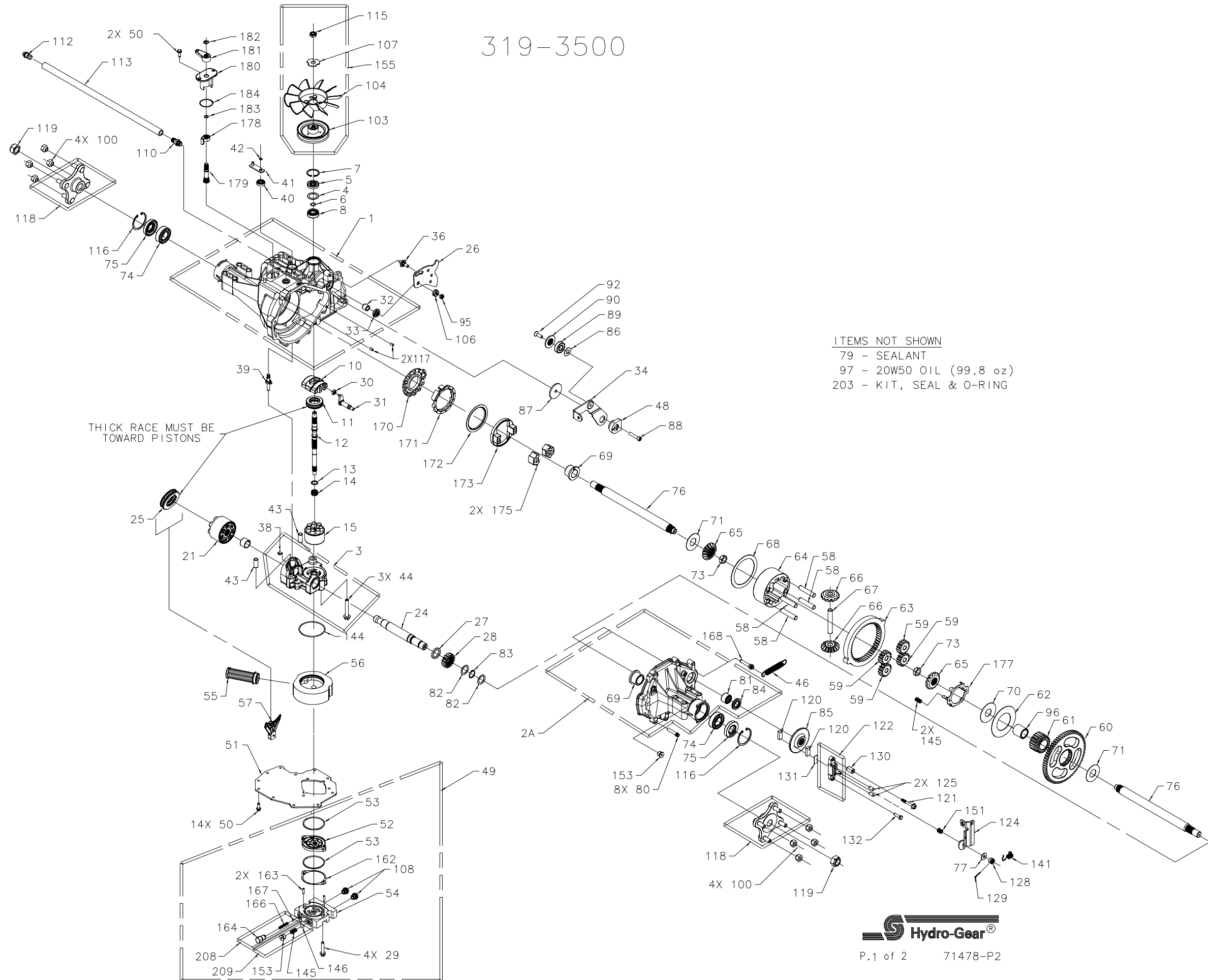

319-3500

ITEM#	PART #	QTY	DESCRIPTION
1	70875	1	ASSEMBLY, MAIN HOUSING
		1	HOUSING, MAIN W/DIFF LOCK
		1	SEAL, LIP 12 X 25 X 7
		1	BEARING, FLANGE 1.0 X 1.376 X .99
		1	BEARING, TRUNNION
		2	BEARING, CRADLE
2A	71120	1	ASSEMBLY, RIGHT HAND HOUSING
		1	HOUSING, RIGHT HAND
		1	BEARING, FLANGE 1.0 X 1.376 X .99
		1	BEARING, NEEDLE .875 X 1.125 X .75
		1	SEAL, LIP .875 X 1.375 X .250
3	70780	1	ASSEMBLY, CENTER SECTION
		1	CENTER SECTION
		1	BEARING, JOURNAL .50 X .59 X .50
		1	BEARING .90 X 1.0 X .75
		1	PLATE, BYPASS
		1	CHECK PLUG ASSEMBLY, .044 BLEED
		1	CHECK PLUG ASSEMBLY, NO BLEED
		3	SCREW, HEX FLANGE 3/8-24 X 2.5
4	2003018	1	SPACER, .98 X 1.37 X .04
5	9008000-0128	1	SEAL, LIP 15 X 35 X 7
6	2003016	1	RING, RETAINING
7	2003052	1	RING, RETAINING
8	2003043	1	BEARING, BALL .59 X 1.38 X .43
10	2003087	1	SWASHPLATE, VARIABLE
11	50551	1	BEARING, THRUST 30 X 52 X 13
12	50960	1	SHAFT, INPUT (AUX CHARGE)
13	2003017	1	WASHER, THRUST .59 X .79 X .04
14	2003014	1	SPRING, BLOCK
15	70723	1	ASSEMBLY, BLOCK
		1	BLOCK, CYLINDER
		7	PISTON
		7	SPRING, COMPRESSION
		7	WASHER, THRUST
21	70082	1	ASSEMBLY, BLOCK
		1	BLOCK, CYLINDER
		7	PISTON
		7	SPRING, COMPRESSION
		7	WASHER, THRUST
24	50662	1	SHAFT, MOTOR
25	50552	1	BEARING, THRUST 42 X 68 X 16
26	51692	1	ARM, CONTROL
27	50774	1	SPACER, 1.03 X 1.38 X .184
28	50661	1	GEAR, 16T PINION
29	51301	2	SCREW, CAP M8 X 1.25 X 40
30	2000015	1	GUIDE, SLOT
31	50807	1	ARM, TRUNNION TAPERED SQUARE
32	2003009	1	BEARING, TRUNNION
33	9008000-0126	1	SEAL, LIP 12 X 25 X 7
34	51127	1	ARM, RETURN
36	50426	1	STUD, SHORT 5/16-24
38	70680	1	KIT, BYPASS PLATE
39	2003555	1	ACTUATOR, BYPASS
40	45074	1	SEAL, LIP 10 X 25 X 7
41	50270	1	ARM, BYPASS
42	44870	1	RING, RETAINING
43	50002	2	PIN, HOLLOW .39 X .50 X 1.12
46	51199	1	SPRING, 4 IN RETURN (MEDIUM)
48	51097	1	PUCK, ADJUSTING
49	71201	1	KIT, AUX
		4	SCREW, CAP M8 X 1.25 X 40
		1	GEROTOR, AUX
		2	O-RING, 2.425 X 2.631
		1	HOUSING, CHARGE PUMP
		1	FILTER, AUX CHARGE
		2	PLUG, 9/16-18 (PLASTIC)
		1	O-RING, 2.987 X 3.09
		1	SPRING, RELIEF
		1	BALL, 7/16 IN
		1	PLUG, 9/16-18 (METAL)
		1	SHIM, AUX MANIFOLD (RED)
		2	PIN, .187 X .75
		1	VALVE BODY, AUX RELIEF
		1	SPRING, AUX RELIEF
		1	BALL, 1/4 IN

ITEM#	PART #	QTY	DESCRIPTION
50	50752	13	SCREW, HEX FLANGE 1/4-20 X .75
51	51302	1	COVER, LOWER W/ AUX
52	51049	1	GEROTOR, AUX
53	9004100-1430	2	O-RING, 2.425 X 2.631
54	70545	1	ASSEMBLY, AUX MANIFOLD
		1	MANIFOLD, AUX
		1	BUSHING, .394 X .472 X .394
55	51308	1	FILTER, AUX CHARGE
56	51303	1	MANIFOLD, AUX/FILTER
57	50796	1	RETAINER, MOTOR BEARING
58	50776	4	PIN, CARRIER
59	50763	4	GEAR, 15T PLANET
60	50646	1	GEAR, 67T SPUR
61	50645	1	GEAR, 21T SUN
62	50769	1	WASHER, THRUST 2.32 X 4.10 X .05
63	50764	1	GEAR, 51T RING
64	50765	1	CARRIER, PLANETARY
65	51431	2	GEAR, 14T STEEL MITER (SPLINED)
66	51432	2	GEAR, 14T STEEL MITER (UNSPLINED)
67	50766	1	SHAFT, DIFFERENTIAL
68	50767	1	WASHER, THRUST 3.46 X 4.39 X .05
69	50768	2	BEARING, FLANGE 1.0 X 1.376 X .99
70	51642	1	WASHER 1.008 X 2.60 X .038
71	50788	2	WASHER 1.0 X 2.25 X .04
73	50791	2	NUT, HEX 5/8-18 W/ PATCH
74	50771	2	BEARING, BALL 25.4 X 52 X 15
75	50772	2	SEAL, LIP 1.0 X 2.049 X .375
76	50825	2	SHAFT, AXLE 1 X 13.84 (30° SPLINED)
77	44130	1	WASHER .34 X .88 X .06
79	50928	10.1oz	SEALANT
80	50868	8	SCREW, TORX HD 5/16-18 X 1.5
81	44752	1	BEARING, NEEDLE .875 X 1.125 X .75
82	50777	2	WASHER, FLAT .88 X 1.25 X .04
83	50775	1	RING, RETAINING
84	50773	1	SEAL, LIP .875 X 1.375 X .250
85	50779	1	DISK, BRAKE
86	50132	1	WASHER .51 X 1.0 X .03
87	50836	1	SPACER, .32 X 1.96 X .15
88	50837	1	SCREW, SOCKET HD CAP 5/16-24 X 1.5
89	44147	1	BEARING, BALL .62 X 1.38 X .44
90	51200	1	SPACER, LOCATING
92	50870	1	SCREW, COUNTERSUNK 5/16-18 X 1.0
95	50108	1	NUT, HEX LOCK 5/16-24 W/NYLON INSERT
96	50866	1	BUSHING, SLEEVE 1.0 X 1.3 X 1.34
97		99.8oz	OIL, 20W-50
100	51656	8	NUT, LUG 7/16-14
102	50813	1	BRACKET, TORQUE
103	51231	1	PULLEY, 3.86 IN
104	51230	1	FAN, 7.0 IN (10 BLADE)
106	51604	1	SPACER, TRUNNION
107	51523	1	WASHER, OD SLOTTED .53 X 1.63 X .06
110	70110	1	ASSEMBLY, FITTING O-RING
112	70109	1	ASSEMBLY, CAP-VENT
113	50838	1	HOSE, 0.5 X 20
115	51244	1	NUT, HEX LOCK 1/2-20 W/ NYLON INSERT
116	50859	2	RING, RETAINING
117	9004800-2506	2	PIN, STANDARD HEADLESS
118	70276	2	ASSEMBLY, HUB
		1	HUB, 4 STUD (PAINTED)
		4	STUD, 7/16-14 X 1.35 (RIB NECK)

ITEM#	PART #	QTY	DESCRIPTION
119	50863	2	NUT, HEX LOCK 3/4-16
120	44132	2	PUCK, BRAKE
121	44433	1	BOLT, HEX HD 1/4-20 X 1 W/ PATCH
122	70633	1	ASSEMBLY, BRAKE YOKE
124	50911	1	ARM, BRAKE
125	44127	2	PIN, BRAKE ACTUATING
128	44142	1	NUT, CASTLE 5/16-24
129	44101	1	PIN, COTTER 3/32 X 3/4
130	23711	1	SPACER, .26 X .57 X .87
131	44134	1	PLATE, PUCK
132	51146	1	BOLT, HEX HD 1/4-20 X 2 W/ PATCH
141	50884	1	SPRING, BRAKE ARM BIAS
144	50974	1	O-RING, 2.987 X 3.09
145	51157	3	SPRING, RELIEF
146	9001214-4400	1	BALL, 7/16 IN
151	50919	1	SPRING, COMP. BRAKE ANTI-DRAW
153	9005110-5600	1	PLUG, 9/16-18 (METAL)
155	70460	1	KIT, FAN/PULLEY
		1	NUT, HEX LOCK 1/2-20 W/ NYLON INSERT
		1	WASHER, OD SLOTTED .53 X 1.63 X .06
		1	FAN 7.0 IN (10 BLADE)
		1	PULLEY, 3.86 IN
162	51148	1	SHIM, AUX MANIFOLD (RED)
163	50408	2	PIN, .187 X .75
164	50967	1	VALVE BODY, AUX RELIEF
166	50968	1	SPRING, AUX RELIEF
167	9001214-2500	1	BALL, 1/4 IN
168	51151	1	SCREW, TORX HD SHOULDERED 5/16-18X1.81
170	51644	1	CAM, STATIONARY
171	51645	1	CAM, ROTATING
172	51646	1	WASHER, THRUST 2.78 X 3.60 X .036
173	51647	1	PLATE, LOAD
175	51648	2	DOG, ENGAGEMENT
177	51649	1	PLATE, GUIDE
178	51650	1	CAM, DIFF LOCK ACTUATING
179	51651	1	SHAFT, DIFF LOCK ACTUATING
180	51613	1	SLEEVE, DIFF LOCK ACTUATING
181	51652	1	ARM, DIFF LOCK ACTUATING
182	51628	1	RING, RETAINING
183	9004101-0120	1	O-RING, .364 X .504
184	51654	1	O-RING, 1.489 X 1.629
203	70492	1	KIT, SEAL & O-RING
		1	SEAL, LIP 10 X 25 X 7
		2	SEAL, LIP 1.0 X 2.049 X .375
		1	SEAL, LIP .875 X 1.375 X .250
		1	SHIM, AUX MANIFOLD (RED)
		1	O-RING, 1.489 X 1.629
		1	KIT, MANIFOLD O-RING
		1	O-RING, 2.425 X 2.631
		1	O-RING, .364 X .504
		1	SEAL, LIP 12 X 25 X 7
		1	SEAL, LIP 15 X 35 X 7
208	2510082	1	KIT, AUX RELIEF VALVE
		1	VALVE BODY, AUX RELIEF
		1	SPRING, AUX RELIEF
		1	BALL, 1/4 IN
209	70544	1	KIT, CHARGE RELIEF
		1	SPRING, RELIEF
		1	BALL, 7/16 IN
		1	PLUG, 9/16-18 (METAL)

