

318-3500

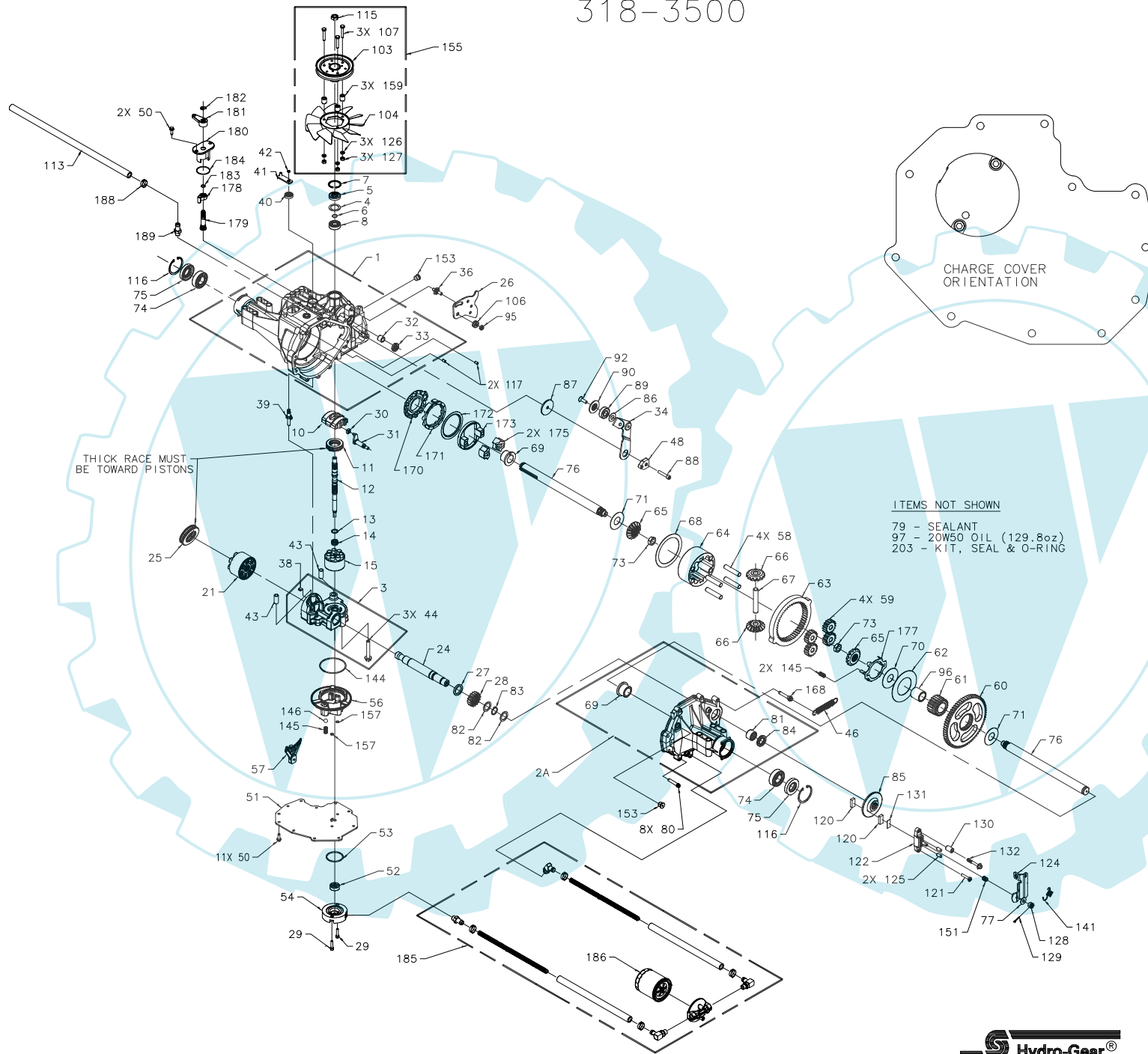

318-3500

ITEM #	PART #	QTY	DESCRIPTION	ITEM #	PART #	QTY	DESCRIPTION	ITEM #	PART #	QTY	DESCRIPTION
1	70876	1	ASSEMBLY, MAIN HOUSING	46	51199	1	SPRING, 4 IN RETURN (MEDIUM)	127	43178	3	NUT, HEX 1/4-20
		1	HOUSING, MAIN, DIFF. CASE DRAIN	48	51097	1	PUCK, ADJUSTING	128	44142	1	NUT, CASTLE 5/16-24
		1	SEAL, LIP 12 X 25 X 7	50	50752	13	SCREW, HEX FLANGE 1/4-20 X .75	129	44101	1	PIN, COTTER 3/32 X 3/4
		1	BEARING, FLANGE 1.0 X 1.376 X .99	51	52206	1	COVER, LOWER W/1 KIDNEY	130	23711	1	SPACER, .26 X .57 X .87
		1	BEARING, TRUNNION	52	50273	1	GEROTOR	131	44134	1	PLATE, PUCK
		2	BEARING, CRADLE	53	9004100-1340	1	O-RING, 1.862 X 2.068	132	51146	1	BOLT, HEX HD 1/4-20 X 2 W/PATCH
2A	71270	1	ASSEMBLY, RIGHT HAND HOUSING	54	52205	1	HOUSING, EXT CHARGE PUMP	141	50884	1	SPRING, BRAKE ARM BIAS
		1	HOUSING, RIGHT HAND, DRAIN	56	51156	1	MANIFOLD, CHARGE	144	50974	1	O-RING, 2.987 X 3.09
		1	BEARING, FLANGE 1.0 X 1.376 X .99	57	50796	1	RETAINER, MOTOR BEARING	145	51157	3	SPRING, RELIEF
		1	BEARING, NEEDLE .875 X 1.125 X .75	58	50776	4	PIN, CARRIER	146	9001214-4400	1	BALL, 7/16 IN
		1	SEAL, LIP .875 X 1.375 X .250	59	50763	4	GEAR, 15T PLANET	151	50919	1	SPRING, COMP. BRAKE ANTI-DRAG
3	70781	1	ASSEMBLY, CENTER SECTION	60	50646	1	GEAR, 67T SPUR	153	9005110-5600	2	PLUG, 9/16-18 (METAL)
		1	CENTER SECTION	61	50645	1	GEAR, 21T SUN	155	70243	1	KIT, FAN/PULLEY
		1	BEARING, JOURNAL .50 X .59 X .50	62	50769	1	WASHER, THRUST 2.32 X 4.10 X .05			1	NUT, HEX 1/2-20 W/PATCH
		1	BEARING, .90 X 1.0 X .75	63	50764	1	GEAR, 51T RING			3	BOLT, 1/4-20 X 1.5 W/PATCH
		1	PLATE, BYPASS	64	50765	1	CARRIER, PLANETARY			1	PULLEY, 4.5 IN
		2	CHECK PLUG ASSEMBLY, .027 BLEED	65	51431	2	GEAR, 14T STEEL MITER (SPLINED)			3	SPACER, .571 X .260 X .618
		3	SCREW, HEX FLANGE 3/8-24 X 2.5	66	51432	2	GEAR, 14T STEEL MITER (UNSPLINED)			1	FAN, 7.0 IN (10 BLADE)
4	2003018	1	SPACER, .98 X 1.37 X .04	67	50766	1	SHAFT, DIFFERENTIAL			3	WASHER, LOCK .489 X .258 X .062
5	9008000-0128	1	SEAL, LIP 15 X 35 X 7	68	50767	1	WASHER, THRUST 3.46 X 4.39 X .05	157	50977	2	NUT, HEX 1/4-20
6	2003016	1	RING, RETAINING	69	50768	2	BEARING, FLANGE 1.0 X 1.376 X .99	159	50259	3	O-RING, .239 X .379
7	2003052	1	RING, RETAINING	70	51642	1	WASHER, 1.008 X 2.60 X .038	168	51151	1	SPACER, .571 X .260 X .618
8	2003043	1	BEARING, BALL .59 X 1.38 X .43	71	50788	2	WASHER, 1.0 X 2.25 X .04	170	51644	1	SCREW, TORX HD SHLDRD 5/16-18 X 1.81
10	2003087	1	SWASHPLATE, VARIABLE	73	50791	2	NUT, HEX 5/8-18 W/PATCH	171	51645	1	CAM, STATIONARY
11	50551	1	BEARING, THRUST 30 X 52 X 13	74	50771	2	BEARING, BALL 25.4 X 52 X 15	172	51646	1	CAM, ROTATING
12	50795	1	SHAFT, INPUT (STD CHARGE)	75	50772	2	SEAL, LIP 1.0 X 2.049 X .375	173	51647	1	WASHER, THRUST 2.78 X 3.60 X .036
13	2003017	1	WASHER, THRUST .59 X .79 X .04	76	50663	2	SHAFT, AXLE 1.0 X 13.80 (KEY)	175	51648	2	PLATE, LOAD
14	2003014	1	SPRING, BLOCK	77	44130	1	WASHER, .34 X .88 X .06	177	51649	1	DOG, ENGAGEMENT
15	70723	1	ASSEMBLY, BLOCK	79	50928	10, 10z	SEALANT	178	51650	1	PLATE, GUIDE
		1	BLOCK, CYLINDER	80	50888	8	SCREW, TORX HD 5/16-18 X 1.5	179	51651	1	CAM, DIFF LOCK ACTUATING
		7	PISTON	81	44752	1	BEARING, NEEDLE .875 X 1.125 X .75	180	51613	1	SHAFT, DIFF LOCK ACTUATING
		7	SPRING, COMPRESSION	82	50777	2	WASHER, FLAT .88 X 1.25 X .04	181	51652	1	SLEEVE, DIFF LOCK ACTUATING
		7	WASHER, THRUST	83	50775	1	RING, RETAINING	182	51628	1	ARM, DIFF LOCK ACTUATING
21	70082	1	ASSEMBLY, BLOCK	84	50773	1	SEAL, LIP .875 X 1.375 X .250	183	9004101-0120	1	RING, RETAINING
		1	BLOCK, CYLINDER	85	50779	1	DISK, BRAKE	184	51654	1	O-RING, .364 X .504
		7	PISTON	86	50132	1	WASHER, .51 X 1.0 X .03	185	71271	1	O-RING, 1.489 X 1.629
		7	SPRING, COMPRESSION	87	50836	1	SPACER, .32 X 1.96 X .15			1	KIT, FILTER ASSEMBLY
		7	WASHER, THRUST	88	50837	1	SCREW, SOCKET HD CAP 5/16-24 X 1.5			1	HEAD, FILTER
24	50662	1	SHAFT, MOTOR	89	44147	1	BEARING, BALL .62 X 1.38 X .44			1	SPIN-ON FILTER
25	50552	1	BEARING, THRUST 42 X 68 X 16	90	51200	1	SPACER, LOCATING			2	FITTING, 90° 9/16 SAE BEADED
26	51692	1	ARM, CONTROL	92	50870	1	SCREW, LOCATING			4	CLAMP, PINCH
27	50774	1	SPACER, 1.03 X 1.38 X .184	95	50108	1	NUT, HEX LOCK 5/16-24 (NYLON INSERT)			1	FITTING, STRAIGHT 9/16 SAE BEADED
28	50661	1	GEAR, 16T PINION	96	50866	1	BUSHING, SLEEVE 1.0 X 1.31 X 1.34			1	FITTING, 60° 9/16 SAE BEADED
29	50975	2	SCREW, CAP M6 X 1 X 25	103	50302	1	OIL, 20W50	186	51563	1	HOSE, 0.5 X 12
30	2000015	1	GUIDE, SLOT	104	50307	1	PULLEY, 4.5 IN	188	50590	1	SPRING, HELICAL COMP 11.5 IN
31	50807	1	ARM, TRUNNION TAPERED SQUARE	106	51604	1	FAN, 7.0 IN (10 BLADE)	189	50591	1	SPIN-ON FILTER
32	2003009	1	BEARING, TRUNNION	107	44276	3	SPACER, TRUNNION	203	70492	1	CLAMP, PINCH
33	9008000-0126	1	SEAL, LIP 12 X 25 X 7	113	50838	1	BOLT, HEX HD 1/4-20 X 1.50 W/PATCH			1	FITTING, STRAIGHT 9/16 SAE BEADED
34	51127	1	ARM, RETURN	115	44133	1	HOSE, 0.5 X 20			1	SEAL, LIP 15 X 35 X 7
36	50426	1	STUD, SHORT 5/16-24	116	50859	2	NUT, HEX 1/2-20 W/PATCH			1	SEAL, LIP 12 X 25 X 7
38	70680	1	KIT, BYPASS PLATE	117	9004800-2506	2	RING, RETAINING			1	SEAL, LIP 10 X 25 X 7
39	2003555	1	ACTUATOR, BYPASS	121	44433	1	PIN, STANDARD HEADLESS			1	O-RING, 1.862 X 2.068
40	45074	1	SEAL, LIP 10 X 25 X 7	122	70633	1	PUCK, BRAKE			2	SEAL, LIP 1.0 X 2.049 X .375
41	50126	1	ARM, BYPASS	124	50911	1	BOLT, HEX HD 1/4-20 X 1 W/PATCH			1	SEAL, LIP .875 X 1.375 X .250
42	44870	1	RING, RETAINING	125	44127	2	ASSEMBLY, BRAKE YOKE			1	O-RING, .239 X .379
43	50002	2	PIN, HOLLOW .39 X .50 X 1.12	126	43177	3	ARM, BRAKE			1	KIT, O-RING, MANIFOLD
44	50016	3	SCREW, HEX FLANGE 3/8-24 X 2.5				PIN, BRAKE ACTUATING			1	O-RING, .364 X .504
							WASHER, LOCK .489 X .258 X .062			1	O-RING, 1.489 X 1.629



P3

ADD'D (QTY 3) 50016 TO ITEM #3 C/S KIT

DEL'D ITEM #2B 71139 KIT, BRAKE BOLT

REV'D ITEM #121 51927 TO 44433

REV'D ITEM #132 51928 TO 51146

04/26/06 K. RAWSKI

LOST EVERYTHING--COMPLETELY REDONE

REV'D ITEM #65 51411 TO 51431

REV'D ITEM #66 51410 TO 51432

09/12/06 J PROBST

ECN #18500