

317-3500

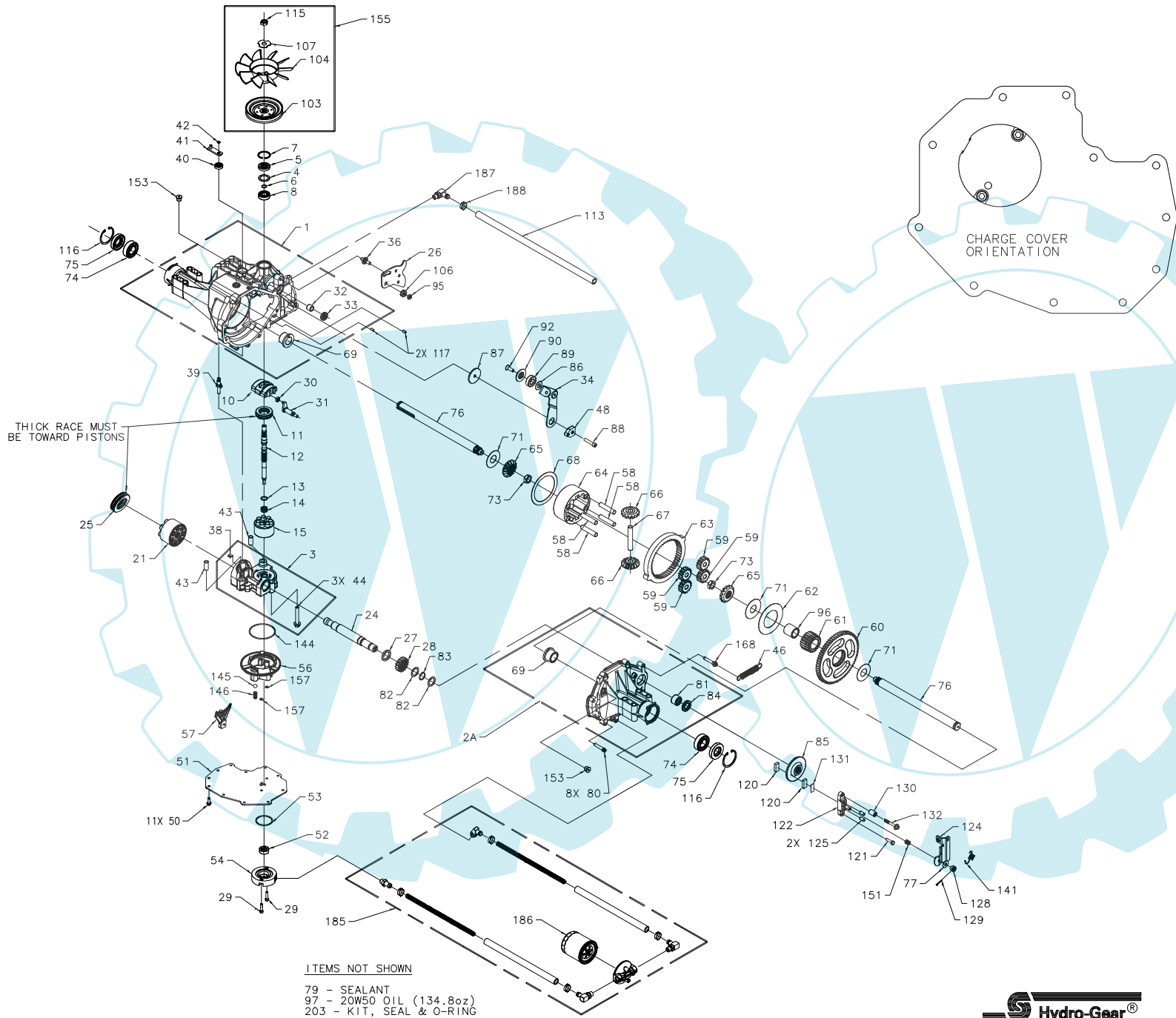

317-3500

| ITEM # | PART #       | QTY | DESCRIPTION                        | ITEM # | PART #       | QTY      | DESCRIPTION                          | ITEM # | PART #       | QTY | DESCRIPTION                           |
|--------|--------------|-----|------------------------------------|--------|--------------|----------|--------------------------------------|--------|--------------|-----|---------------------------------------|
| 1      | 70433        | 1   | ASSEMBLY, MAIN HOUSING             | 34     | 51127        | 1        | ARM, RETURN                          | 107    | 51523        | 1   | WASHER, OD SLOTTED .53 X 1.63 X .06   |
|        |              | 1   | HOUSING, MAIN, CASE DRAIN          | 36     | 50426        | 1        | STUD, SHORT 5/16-24                  | 113    | 50838        | 1   | HOSE, 0.5 X 20                        |
|        |              | 1   | SEAL, LIP 12 X 25 X 7              | 38     | 70680        | 1        | KIT, BYPASS PLATE                    | 115    | 44133        | 1   | NUT, HEX 1/2-20 W/PATCH               |
|        |              | 1   | BEARING, FLANGE 1.0 X 1.376 X .99  | 39     | 2003555      | 1        | ACTUATOR, BYPASS                     | 116    | 50859        | 2   | RING, RETAINING                       |
|        |              | 1   | BEARING, TRUNNION                  | 40     | 45074        | 1        | SEAL, LIP 10 X 25 X 7                | 117    | 9004800-2506 | 2   | PIN, STANDARD HEADLESS                |
|        |              | 2   | BEARING, CRADLE                    | 41     | 50270        | 1        | ARM, BYPASS                          | 120    | 44132        | 2   | PUCK, BRAKE                           |
| 2A     | 71270        | 1   | ASSEMBLY, RIGHT HAND HOUSING       | 42     | 44870        | 1        | RING, RETAINING                      | 121    | 44433        | 1   | BOLT, HEX HD 1/4-20 X 1 W/PATCH       |
|        |              | 1   | HOUSING, RIGHT HAND, DRAIN         | 43     | 50002        | 2        | PIN, HOLLOW .39 X .50 X 1.12         | 122    | 70633        | 1   | ASSEMBLY, BRAKE YOKE                  |
|        |              | 1   | BEARING, FLANGE 1.0 X 1.376 X .99  | 44     | 50016        | 3        | SCREW, HEX FLANGE 3/8-24 X 2.5       | 124    | 50911        | 1   | ARM, BRAKE                            |
|        |              | 1   | BEARING, NEEDLE .875 X 1.125 X .75 | 46     | 51199        | 1        | SPRING, 4 IN RETURN (MEDIUM)         | 125    | 44127        | 2   | PIN, BRAKE ACTUATING                  |
|        |              | 1   | SEAL, LIP .875 X 1.375 X .250      | 48     | 51097        | 1        | PUCK, ADJUSTING                      | 128    | 44142        | 1   | NUT, CASTLE 5/16-24                   |
| 2B     | 71139        | 1   | KIT, BRAKE BOLT                    | 50     | 50752        | 11       | SCREW, HEX FLANGE 1/4-20 X .75       | 129    | 44101        | 1   | PIN, COTTER 3/32 X 3/4                |
|        |              | 1   | BOLT, HEX HD 1/4-20 X 1.25 W/PATCH | 51     | 52206        | 1        | COVER, LOWER W/1 KIDNEY              | 130    | 23711        | 1   | SPACER, .26 X .57 X .87               |
|        |              | 1   | BOLT, HEX HD 1/4-20 X 2.25 W/PATCH | 52     | 50273        | 1        | GEROTOR                              | 131    | 44134        | 1   | PLATE, PUCK                           |
| 3      | 71272        | 1   | ASSEMBLY, CENTER SECTION           | 53     | 9004100-1340 | 1        | O-RING, 1.862 X 2.068                | 132    | 51146        | 1   | BOLT, HEX HD 1/4-20 X 2 W/PATCH       |
|        |              | 1   | CENTER SECTION                     | 54     | 52205        | 1        | HOUSING, EXT CHARGE PUMP             |        |              |     |                                       |
|        |              | 1   | BEARING, JOURNAL .50 X .59 X .50   | 56     | 51156        | 1        | MANIFOLD, CHARGE                     | 141    | 50884        | 1   | SPRING, BRAKE ARM BIAS                |
|        |              | 1   | BEARING, .90 X 1.0 X .75           | 57     | 50796        | 1        | RETAINER, MOTOR BEARING              | 144    | 50974        | 1   | O-RING, 2.987 X 3.09                  |
|        |              | 1   | PLATE, BYPASS                      | 58     | 50776        | 4        | PIN, CARRIER                         | 145    | 51157        | 1   | SPRING, RELIEF                        |
|        |              | 2   | CHECK PLUG ASSEMBLY, .027 SPRING   | 59     | 50763        | 4        | GEAR, 15T PLANET                     | 146    | 9001214-4400 | 1   | BALL, 7/16 IN                         |
|        |              | 3   | SCREW, HEX FLANGE 3/8-24 X 2.5     | 60     | 50646        | 1        | GEAR, 67T SPUR                       | 151    | 50919        | 1   | SPRING, COMP. BRAKE ANTI-DRAG         |
| 4      | 2003018      | 1   | SPACER, .98 X 1.37 X .04           | 61     | 50645        | 1        | GEAR, 21T SUN                        | 153    | 9005110-5600 | 2   | PLUG, 9/16-18 (METAL)                 |
| 5      | 9008000-0128 | 1   | SEAL, LIP 15 X 35 X 7              | 62     | 50769        | 1        | WASHER, THRUST 2.32 X 4.10 X .05     | 155    | 70489        | 1   | KIT, FAN/PULLEY                       |
| 6      | 2003016      | 1   | RING, RETAINING                    | 63     | 50764        | 1        | GEAR, 51T RING                       |        |              |     |                                       |
| 7      | 2003052      | 1   | RING, RETAINING                    | 64     | 50765        | 1        | CARRIER, PLANETARY                   |        |              |     |                                       |
| 8      | 2003043      | 1   | BEARING, BALL .59 X 1.38 X .43     | 65     | 51431        | 2        | GEAR, 14T STEEL MITER (SPLINED)      |        |              |     |                                       |
| 10     | 2003087      | 1   | SWASHPLATE, VARIABLE               | 66     | 51432        | 2        | GEAR, 14T STEEL MITER (UNSPLINED)    |        |              |     |                                       |
| 11     | 50551        | 1   | BEARING, THRUST 30 X 52 X 13       | 67     | 50766        | 1        | SHAFT, DIFFERENTIAL                  | 157    | 50977        | 2   | O-RING, .239 X .379                   |
| 12     | 50795        | 1   | SHAFT, INPUT (STD CHARGE)          | 68     | 50767        | 1        | WASHER, THRUST 3.46 X 4.39 X .05     | 168    | 51151        | 1   | SCREW, TORX HD SHLDRED 5/16-18 X 1.81 |
| 13     | 2003017      | 1   | WASHER, THRUST .59 X .79 X .04     | 69     | 50768        | 2        | BEARING, FLANGE 1.0 X 1.376 X .99    | 185    | 71271        | 1   | KIT, FILTER ASSEMBLY                  |
| 14     | 2003014      | 1   | SPRING, BLOCK                      | 71     | 50788        | 3        | WASHER, 1.0 X 2.25 X .04             |        |              |     |                                       |
| 15     | 70723        | 1   | ASSEMBLY, BLOCK                    | 73     | 50791        | 2        | NUT, HEX 5/8-18 W/PATCH              |        |              |     |                                       |
|        |              | 1   | BLOCK, CYLINDER                    | 74     | 50771        | 2        | BEARING, BALL 25.4 X 52 X 15         |        |              |     |                                       |
|        |              | 7   | PISTON                             | 75     | 50772        | 2        | SEAL, LIP 1.0 X 2.049 X .375         |        |              |     |                                       |
|        |              | 7   | SPRING, COMPRESSION                | 76     | 50663        | 2        | SHAFT, AXLE 1.0 X 13.80 (KEY)        |        |              |     |                                       |
|        |              | 7   | WASHER, THRUST                     | 77     | 44130        | 1        | WASHER, .34 X .88 X .06              |        |              |     |                                       |
| 21     | 70082        | 1   | ASSEMBLY, BLOCK                    | 79     | 50928        | 10, 1oz  | SEALANT                              |        |              |     |                                       |
|        |              | 1   | BLOCK, CYLINDER                    | 80     | 50868        | 8        | SCREW, TORX HD 5/16-18 X 1.5         |        |              |     |                                       |
|        |              | 7   | PISTON                             | 81     | 44752        | 1        | BEARING, NEEDLE .875 X 1.125 X .75   | 186    | 51563        | 1   | SPIN-ON FILTER                        |
|        |              | 7   | SPRING, COMPRESSION                | 82     | 50777        | 2        | WASHER, FLAT .88 X 1.25 X .04        | 187    | 50589        | 1   | FITTING, 90° 9/16 SAE BEADED          |
|        |              | 7   | WASHER, THRUST                     | 83     | 50775        | 1        | RING, RETAINING                      | 188    | 50590        | 1   | CLAMP, PINCH                          |
|        |              | 1   | SHAFT, MOTOR                       | 84     | 50773        | 1        | SEAL, LIP .875 X 1.375 X .250        | 203    | 70492        | 1   | KIT, SEAL & O-RING                    |
| 24     | 50662        | 1   | BEARING, THRUST 42 X 68 X 16       | 85     | 50779        | 1        | DISK, BRAKE                          |        |              |     |                                       |
| 25     | 50552        | 1   | ARM, CONTROL                       | 86     | 50132        | 1        | WASHER, .51 X 1.0 X .03              |        |              |     |                                       |
| 26     | 51692        | 1   | SPACER, 1.03 X 1.38 X .184         | 87     | 50836        | 1        | SPACER, .32 X 1.96 X .15             |        |              |     |                                       |
| 27     | 50774        | 1   | GEAR, 16T PINION                   | 88     | 50837        | 1        | SCREW, SOCKET HD CAP 5/16-24 X 1.5   |        |              |     |                                       |
| 28     | 50661        | 1   | SCREW, CAP M6 X 1 X 25             | 89     | 44147        | 1        | BEARING, BALL .62 X 1.38 X .44       |        |              |     |                                       |
| 29     | 50975        | 2   | GUIDE, SLOT                        | 90     | 51200        | 1        | SPACER, LOCATING                     |        |              |     |                                       |
| 30     | 2000015      | 1   | ARM, TRUNNION TAPERED SQUARE       | 92     | 50870        | 1        | SCREW, COUNTERSUNK 5/16-18 X 1.0     |        |              |     |                                       |
| 31     | 50807        | 1   | BEARING, TRUNNION                  | 95     | 50108        | 1        | NUT, HEX LOCK 5/16-24 (NYLON INSERT) |        |              |     |                                       |
| 32     | 2003009      | 1   | BEARING, TRUNNION                  | 96     | 50866        | 1        | BUSHING, SLEEVE 1.0 X 1.31 X 1.34    |        |              |     |                                       |
| 33     | 9008000-0126 | 1   | SEAL, LIP 12 X 25 X 7              | 97     |              | 134, 8oz | OIL, 20W50                           |        |              |     |                                       |
|        |              |     |                                    | 103    | 51875        | 1        | PULLEY, 4.5 IN                       |        |              |     |                                       |
|        |              |     |                                    | 104    | 51862        | 1        | FAN, 7.0 IN (10 BLADE)               |        |              |     |                                       |
|        |              |     |                                    | 106    | 51604        | 1        | SPACER, TRUNNION                     |        |              |     |                                       |



P3

ADD'D (QTY 3) 50016 TO ITEM #3 C/S KIT

DEL'D ITEM #2B 71139 KIT, BRAKE BOLT

REV'D ITEM #121 51927 TO 44433

REV'D ITEM #132 51928 TO 51146

DEL'D ITEM #139 44278 WASHER

04/24/06 K. RAWSKI

REV'D ITEM #65 51411 TO 51431

REV'D ITEM #66 51410 TO 51432

08/24/06 J PROBST

ECN #18482