

314-1700

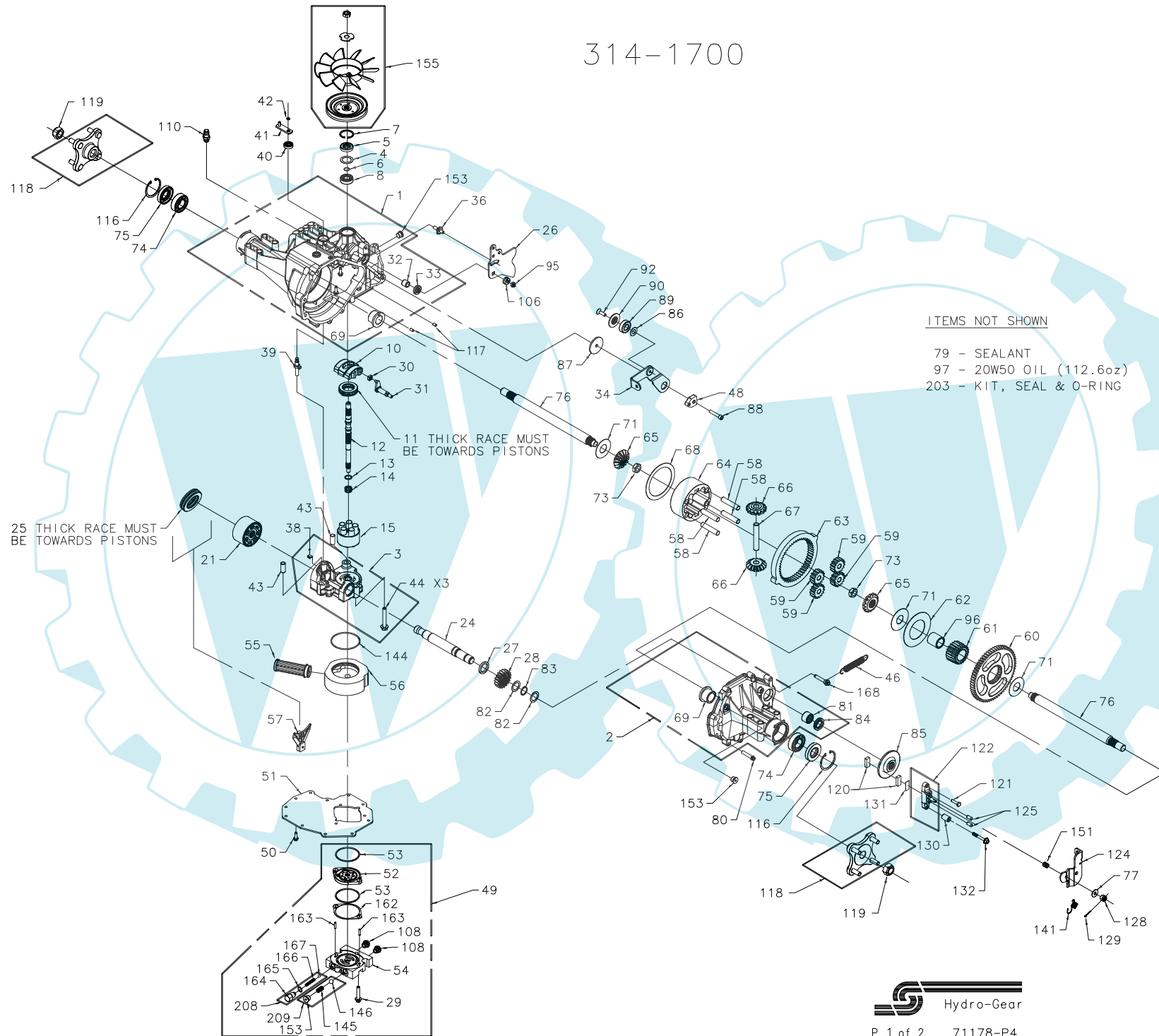

314-1700

ITEM#	PART #	QTY	DESCRIPTION	ITEM#	PART #	QTY	DESCRIPTION	ITEM#	PART #	QTY	DESCRIPTION
1	70433	1	ASSEMBLY, MAIN HOUSING	49	71201	1	KIT, AUX	106	51604	1	SPACER, TRUNNION
		1	HOUSING, MAIN, CASE DRAIN			4	SCREW, CAP M8 X 1.25 X 40	107	51523	1	WASHER, OD SLOTTED .53 X 1.63 X .06
		1	SEAL, LIP 12 X 25 X 7			1	GEROTOR, AUX	108	9005200-5600	2	PLUG, 9/16-18 (PLASTIC)
		1	BEARING, FLANGE 1.0 X 1.376 X .99			2	O-RING, 2.425 X 2.631	110	70110	1	ASSEMBLY, FITTING O-RING
		1	BEARING, TRUNNION			1	HOUSING, CHARGE PUMP	115	44133	1	NUT, HEX 1/2-20 W/ PATCH
		2	BEARING, CRADLE			1	FILTER, AUX CHARGE	116	50859	2	RING, RETAINING
2	71120	1	ASSEMBLY, RIGHT HAND HOUSING			2	PLUG, 9/16-18 (PLASTIC)	117	9004800-2506	2	PIN, STANDARD HEADLESS
		1	HOUSING, RIGHT HAND			1	O-RING, 2.987 X 3.09	118	70314	2	ASSEMBLY, HUB
		1	BEARING, FLANGE 1.0 X 1.376 X .99			1	SPRING, RELIEF			4	HUB, 4 STUD (PAINTED)
		1	BEARING, NEEDLE .875 X 1.125 X .75			1	BALL, 7/16 IN			1	STUD, 1/2-20 X 1.55 (RIB NECK)
		1	SEAL, LIP .875 X 1.375 X .250			1	PLUG, 9/16-18 (METAL)	119	50863	2	NUT, HEX LOCK 3/4-16
3	71180	1	ASSEMBLY, CENTER SECTION			1	SHIM, AUX MANIFOLD (RED)	120	44132	2	PUCK, BRAKE
		1	CENTER SECTION			2	PIN, .187 X .75	121	44433	1	BOLT, HEX HD 1/4-20 X 1 W/PATCH
		1	BEARING, JOURNAL .50 X .59 X .50			1	VALVE BODY, AUX RELIEF	122	70633	1	ASSEMBLY, BRAKE YOKE
		1	BEARING .90 X 1.02 X .75			1	SPRING, AUX RELIEF	124	50916	1	ARM, BRAKE
		1	PLATE, BYPASS			1	BALL, 1/4 IN	125	44127	2	PIN, BRAKE ACTUATING
		1	SHOCK VALVE ASSEMBLY, NO BLEED	50	50752	11	SCREW, HEX FLANGE 1/4-20 X .75	128	44142	1	NUT, CASTLE 5/16-24
		1	CHECK PLUG ASSEMBLY, .027	51	51302	1	COVER, LOWER W/ AUX	129	44101	1	PIN, COTTER 3/32 X 3/4
		3	SCREW, HEX FLANGE 3/8-24 X 2.5	52	51049	1	GEROTOR, AUX	130	23711	1	SPACER, .26 X .57 X .87
4	2003018	1	SPACER, .98 X 1.37 X .04	53	9004100-1430	2	O-RING, 2.425 X 2.631	131	44134	1	PLATE, PUCK
5	9008000-0128	1	SEAL, LIP 15 X 35 X 7	54	70545	1	ASSEMBLY, AUX MANIFOLD	132	51146	1	BOLT, HEX HD 1/4-20 X 2 W/PATCH
6	2003016	1	RING, RETAINING	55	51308	1	FILTER, AUX CHARGE	133	44431	8	STUD, 1/2-20 X 1.55 (RIB NECK)
7	2003052	1	RING, RETAINING	56	51303	1	MANIFOLD, AUX/FILTER	141	50884	1	SPRING, BRAKE ARM BIAS
8	2003043	1	BEARING, BALL .59 X 1.38 X .43	57	50796	1	RETAINER, MOTOR BEARING	144	50974	1	O-RING, 2.987 X 3.09
10	2003087	1	SWASHPLATE, VARIABLE	58	50776	4	PIN, CARRIER	145	51157	1	SPRING, RELIEF
11	50551	1	BEARING, THRUST 30 X 52 X 13	59	50763	4	GEAR, 15T PLANET	146	9001214-4400	1	BALL, 7/16 IN
12	50960	1	SHAFT, INPUT (AUX CHARGE)	60	51599	1	GEAR, 64T SPUR	151	50919	1	SPRING, COMP. BRAKE ANTI-DRAG
13	2003017	1	WASHER, THRUST .59 X .79 X .04	61	50645	1	GEAR, 21T SUN	153	9005110-5600	3	PLUG, 9/16-18 (METAL)
14	2003014	1	SPRING, BLOCK	62	50769	1	WASHER, THRUST 2.32 X 4.10 X .05	155	70489	1	KIT, FAN/PULLEY
15	70331	1	ASSEMBLY, BLOCK	63	50764	1	GEAR, 51T RING			1	NUT, HEX 1/2-20 W/ PATCH
		1	BLOCK, CYLINDER	64	50765	1	CARRIER, PLANETARY			1	WASHER, O.D SLOTTED, .53 X 1.63 X .06
		5	PISTON	65	50647	2	GEAR, 14T MITER (SPLINED)			1	FAN, 7.0 IN (10 BLADE)
		5	SPRING, COMPRESSION	66	50648	2	GEAR, 14T MITER (UNSPLINED)			1	PULLEY, 4.5 IN
		5	WASHER, THRUST	67	50766	1	SHAFT, DIFFERENTIAL				
21	70082	1	ASSEMBLY, BLOCK	68	50767	1	WASHER, THRUST 3.46 X 4.39 X .05	162	51148	1	SHIM, AUX MANIFOLD (RED)
		1	BLOCK, CYLINDER	69	50768	2	BEARING, FLANGE 1.0 X 1.376 X .99	163	50408	2	PIN .187 X .75
		7	PISTON	71	50788	3	WASHER 1.0 X 2.25 X .04	164	50967	1	VALVE BODY, AUX RELIEF
		7	SPRING, COMPRESSION	73	50791	2	NUT, HEX 5/8-18 W/ PATCH	166	50968	1	SPRING, AUX RELIEF
		7	WASHER, THRUST	74	50771	2	BEARING, BALL 25.4 X 52 X 15	167	9001214-2500	1	BALL, 1/4 IN
24	50662	1	SHAFT, MOTOR	75	50772	2	SEAL, LIP 1.0 X 2.049 X .375	168	51151	1	SCREW, TORX HD SHOULDERED 5/16-18 X 1.81
25	50552	1	BEARING, THRUST 42 X 68 X 16	76	50825	2	SHAFT, AXLE 1.0 X 13.84 (30° SPLINED)	203	70492	1	KIT, SEAL & O-RING
26	51250	1	ARM, CONTROL	77	44130	1	WASHER .34 X .88 X .06			1	SEAL, LIP 10 X 25 X 7
27	50774	1	SPACER, 1.03 X 1.38 X .184	79	50928	10, 1oz	SEALANT			2	SEAL, LIP 1.0 X 2.049 X .375
28	51600	1	GEAR, 19T PINION	80	50868	8	SCREW, TORX HEAD 5/16-18 X 1.5			1	SEAL, LIP .875 X 1.375 X .250
29	51301	4	SCREW, CAP M8 X 1.25 X 40	81	44752	1	BEARING, NEEDLE .875 X 1.125 X .75			2	O-RING, 2.987 X 3.09
30	2000015	1	GUIDE, SLOT	82	50777	2	WASHER, FLAT .88 X 1.25 X .04			1	SHIM, AUX MANIFOLD (RED)
31	50807	1	ARM, TRUNNION TAPERED SQUARE	83	50775	1	RING, RETAINING			2	O-RING, 2.425 X 2.631
32	2003009	1	BEARING, TRUNNION	84	50773	1	SEAL, LIP .875 X 1.375 X .250			1	SEAL, LIP 15 X 35 X 7
33	9008000-0126	1	SEAL, LIP 12 X 25 X 7	85	50779	1	DISK, BRAKE			2	SEAL, LIP 12 X 25 X 7
34	51127	1	ARM, RETURN	86	50132	1	WASHER .51 X 1.0 X .03			1	KIT, AUX RELIEF VALVE
36	50426	1	STUD, SHORT 5/16-24	87	50836	1	WASHER .32 X 1.96 X .15	208	2510082	1	VALVE BODY, AUX RELIEF
38	70680	1	KIT, BYPASS PLATE	88	50837	1	SCREW, SOCKET HD CAP 5/16-24 X 1.5			1	SPRING, AUX RELIEF
39	2003555	1	ACTUATOR, BYPASS	89	44147	1	BEARING, BALL .62 X 1.38 X .44			1	BALL, 1/4 IN
40	45074	1	SEAL, LIP 10 X 25 X 7	90	51200	1	SPACER, LOCATING	209	70544	1	KIT, CHARGE RELIEF
41	50270	1	ARM, BYPASS	92	50870	1	SCREW, COUNTERSUNK 5/16-18 X 1.0			1	SPRING, RELIEF
42	44870	1	RING, RETAINING	95	50108	1	NUT, HEX LOCK 5/16-24 W/NYLON INSERT			1	BALL, 7/16 IN
43	50002	2	PIN, HOLLOW .39 X .50 X 1.12	96	50866	1	BUSHING, SLEEVE 1.0 X 1.3 X 1.34			1	PLUG, 9/16-18 (METAL)
44	50016	3	SCREW, HEX FLANGE 3/8-24 X 2.5	97		112, 6oz	OIL, 20W50				
46	51199	1	SPRING, 4 IN RETURN (MEDIUM)	103	51875	1	PULLEY, 4.5 IN				
48	51097	1	PUCK, ADJUSTING	104	51862	1	FAN, 7.0 IN (10 BLADE)				