

312-1500

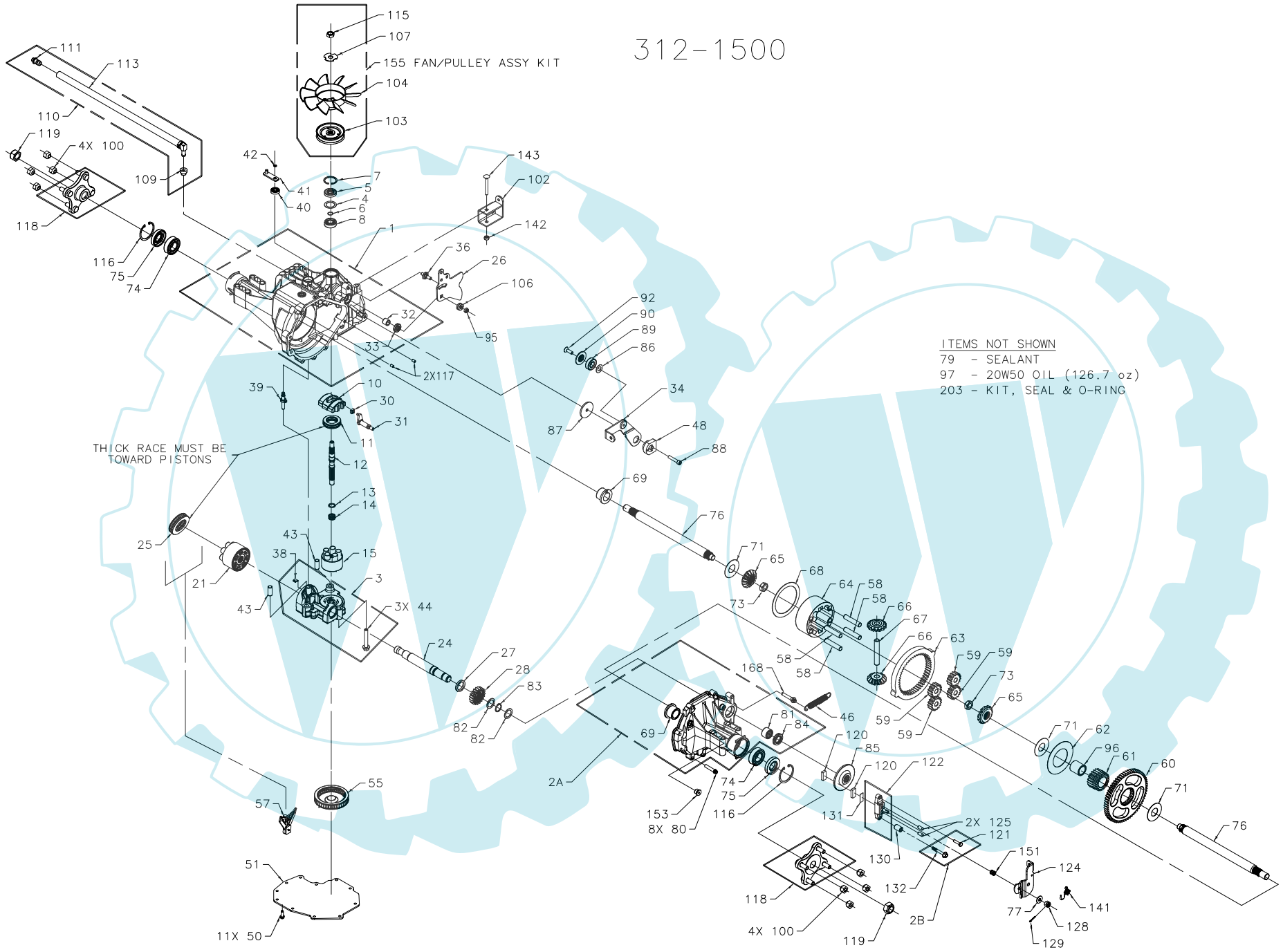

ITEMS NOT SHOWN

- 79 - SEALANT
- 97 - 20W50 OIL (126.7 oz)
- 203 - KIT, SEAL & O-RING

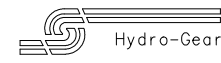

312-1500

ITEM#	PART #	QTY	DESCRIPTION	ITEM#	PART #	QTY	DESCRIPTION	ITEM#	PART #	QTY	DESCRIPTION
1	70297	1	ASSEMBLY, MAIN HOUSING	39	2003555	1	ACTUATOR, BYPASS	109	50133	1	BUSHING, VENT (RUBBER)
		1	HOUSING, MAIN	40	45074	1	SEAL, LIP 10 X 25 X 7	110	70302	1	KIT, FITTING
		1	SEAL, LIP 12 X 25 X 7	41	50270	1	ARM, BYPASS	1		1	BUSHING, VENT (RUBBER)
		1	BEARING, FLANGE 1.0 X 1.376 X .99	42	44870	1	RING, RETAINING	1		1	ASSEMBLY, CAP-VENT
		1	BEARING, TRUNNION	43	50002	2	PIN, HOLLOW .39 X .50 X 1.12	111	70109	1	KIT, 90° FITTING & HOSE ASS'Y
		2	BEARING, CRADLE	44	50016	3	SCREW, HEX FLANGE 3/8-24 X 2.5	1		1	ASSEMBLY, CAP-VENT
2A	71120	1	ASSEMBLY, RIGHT HAND HOUSING	46	51199	1	SPRING, 4 IN RETURN (MEDIUM)	113	70301	1	KIT, 90° FITTING & HOSE ASS'Y
		1	HOUSING, RIGHT HAND	48	51097	1	PUCK, ADJUSTING	1		1	FITTING, 90° METAL VENT
		1	BEARING, FLANGE 1.0 X 1.376 X .99	50	50752	11	SCREW, HEX FLANGE 1/4-20 X .75	1		1	CLAMP, PINCH
		1	BEARING, NEEDLE .875 X 1.125 X .75	51	51128	1	COVER, LOWER W/O KIDNEYS	1		1	HOSE, .5 X 20
		1	SEAL, LIP .875 X 1.375 X .250	55	50990	1	FILTER, NO CHARGE	115	44133	1	NUT, HEX 1/2-20 W/ PATCH
2B	71139	1	KIT, BRAKE BOLT	57	50796	1	RETAINER, MOTOR BEARING	116	50859	2	RING, RETAINING
		1	BOLT, HEX HD 1/4-20 X 1 W/PATCH	58	50776	4	PIN, CARRIER	117	9004800-2506	2	PIN, STANDARD HEADLESS
		1	BOLT, HEX HD 1/4-20 X 2 W/PATCH	59	50763	4	GEAR, 15T PLANET	118	70276	2	ASSEMBLY, HUB
3	70913	1	ASSEMBLY, CENTER SECTION	60	51599	4	GEAR, 64T SPUR	4		4	HUB, 4 STUD (PAINTED)
		1	CENTER SECTION	61	50645	1	GEAR, 21T SUN	1		1	STUD, 7/16-14 X 1.35 (RIB NECK)
		1	BEARING .90 X 1.0 X .75	62	50769	1	WASHER, THRUST 2.32 X 4.10 X .05	119	50863	2	NUT, HEX LOCK 3/4-16
		1	PLATE, BYPASS	63	50764	1	GEAR, 51T RING	120	44132	2	PUCK, BRAKE
		1	CHECK PLUG ASSEMBLY, NO BLEED	64	50765	1	CARRIER, PLANETARY	121	44433	1	BOLT, HEX HD 1/4-20 X 1 W/PATCH
		1	CHECK PLUG ASSEMBLY, .027 BLEED	65	50647	2	GEAR, 14T MITER (SPLINED)	122	70633	1	ASSEMBLY, BRAKE YOKE
		3	SCREW, HEX FLANGE 3/8-24 X 2.5	66	50648	2	GEAR, 14T MITER (UNSPLINED)	124	50916	1	ARM, BRAKE
4	2003018	1	SPACER, .98 X 1.37 X .04	67	50766	1	SHAFT, DIFFERENTIAL	125	44127	2	PIN, BRAKE ACTUATING
5	9008000-0128	1	SEAL, LIP 15 X 35 X 7	68	50767	1	WASHER, THRUST 3.46 X 4.39 X .05	128	44142	1	NUT, CASTLE 5/16-24
6	2003016	1	RING, RETAINING	69	50768	2	BEARING, FLANGE 1.0 X 1.376 X .99	129	44101	1	PIN, COTTER 3/32 X 3/4
7	2003052	1	RING, RETAINING	71	50788	3	WASHER, 1.0 X 2.25 X .04	130	23711	1	SPACER, .26 X .57 X .87
8	2003043	1	BEARING, BALL .59 X 1.38 X .43	73	50791	2	NUT, HEX 5/8-18 W/ PATCH	131	44134	1	PLATE, PUCK
10	2003087	1	SWASHPLATE, VARIABLE	74	50771	2	BEARING, BALL 25.4 X 52 X 15	132	51146	1	BOLT, HEX HD 1/4-20 X 2 W/PATCH
11	50551	1	BEARING, THRUST 30 X 52 X 13	75	50772	2	SEAL, LIP 1.0 X 2.049 X .375	141	50884	1	SPRING, BRAKE ARM BIAS
12	50005	1	SHAFT, INPUT (NO CHARGE)	76	50825	2	SHAFT, AXLE, 1.0 X 13.84 (30° SPLINED)	142	43064	1	NUT, HEX LOCK 5/16-18
13	2003017	1	WASHER, THRUST .59 X .79 X .04	77	44130	1	WASHER, .34 X .88 X .06	143	50886	1	BOLT, 5/16-18 X 2.5
14	2003014	1	SPRING, BLOCK	79	50928	10.1oz	SEALANT	151	50919	1	SPRING, COMP. BRAKE ANTI-Drag
15	70331	1	ASSEMBLY, BLOCK	80	50868	8	SCREW, TORX HD 5/16-18 X 1.5	153	9005110-5600	1	PLUG, 9/16-18 (METAL)
		1	BLOCK, CYLINDER	81	44752	1	BEARING, NEEDLE .875 X 1.125 X .75	155	70995	1	KIT, FAN/PULLEY
		5	PISTON	82	50777	2	WASHER, FLAT .88 X 1.25 X .04	1		1	NUT, HEX 1/2-20 W/ PATCH
		5	SPRING, COMPRESSION	83	50775	1	RING, RETAINING	1		1	WASHER, OD SLOTTED .53 X 1.63 X .06
		5	WASHER, THRUST	84	50773	1	SEAL, LIP .875 X 1.375 X .250	1		1	FAN, 7.0 IN (10 BLADE)
21	70082	1	ASSEMBLY, BLOCK	85	50779	1	DISK, BRAKE	1		1	PULLEY, 3.25 IN
		1	BLOCK, CYLINDER	86	50132	1	WASHER, .51 X 1.0 X .03	168	51151	1	SCREW, TORX HD SHOULDERED 5/16-18 X 1.81
		7	PISTON	87	50836	1	SPACER, .32 X 1.96 X .15	203	70492	1	KIT, SEAL & O-RING
		7	SPRING, COMPRESSION	88	50837	1	SCREW, SOCKET HD CAP 5/16-24 X 1.5	1		1	SEAL, LIP 10 X 25 X 7
		7	WASHER, THRUST	89	44147	1	BEARING, BALL .62 X 1.38 X .44	2		2	SEAL, LIP 1.0 X 2.049 X .375
24	50662	1	SHAFT, MOTOR	90	51200	1	SPACER, LOCATING	1		1	SEAL, LIP .875 X 1.375 X .250
25	50552	1	BEARING, THRUST 42 X 68 X 16	92	50870	1	SCREW, COUNTERSUNK 5/16-18 X 1.0	1		1	SEAL, LIP 12 X 25 X 7
26	51250	1	ARM, CONTROL	95	50108	1	NUT, HEX LOCK 5/16-24 W/NYLON INSERT	1		1	SEAL, LIP 15 X 35 X 7
27	50774	1	SPACER, 1.03 X 1.38 X .184	96	50866	1	BUSHING, SLEEVE 1.0 X 1.3 X 1.34				
28	51600	1	GEAR, 19T PINION	97			OIL, 20W-50				
30	2000015	1	GUIDE, SLOT	100	51656	126.7oz	NUT, LUG 7/16-14				
31	50807	1	ARM, TRUNNION TAPERED SQUARE	102	50813	1	BRACKET, TORQUE				
32	2003009	1	BEARING, TRUNNION	103	51925	1	PULLEY, 3.25 IN				
33	9008000-0126	1	SEAL, LIP 12 X 25 X 7	104	51862	1	FAN, 7.0 IN (10 BLADE)				
34	51127	1	ARM, RETURN	106	51604	1	SPACER, TRUNNION				
36	50426	1	STUD, SHORT 5/16-24	107	51523	1	WASHER, OD SLOTTED .53 X 1.63 X .06				
38	70680	1	KIT, BYPASS PLATE								