

199650
318-0610

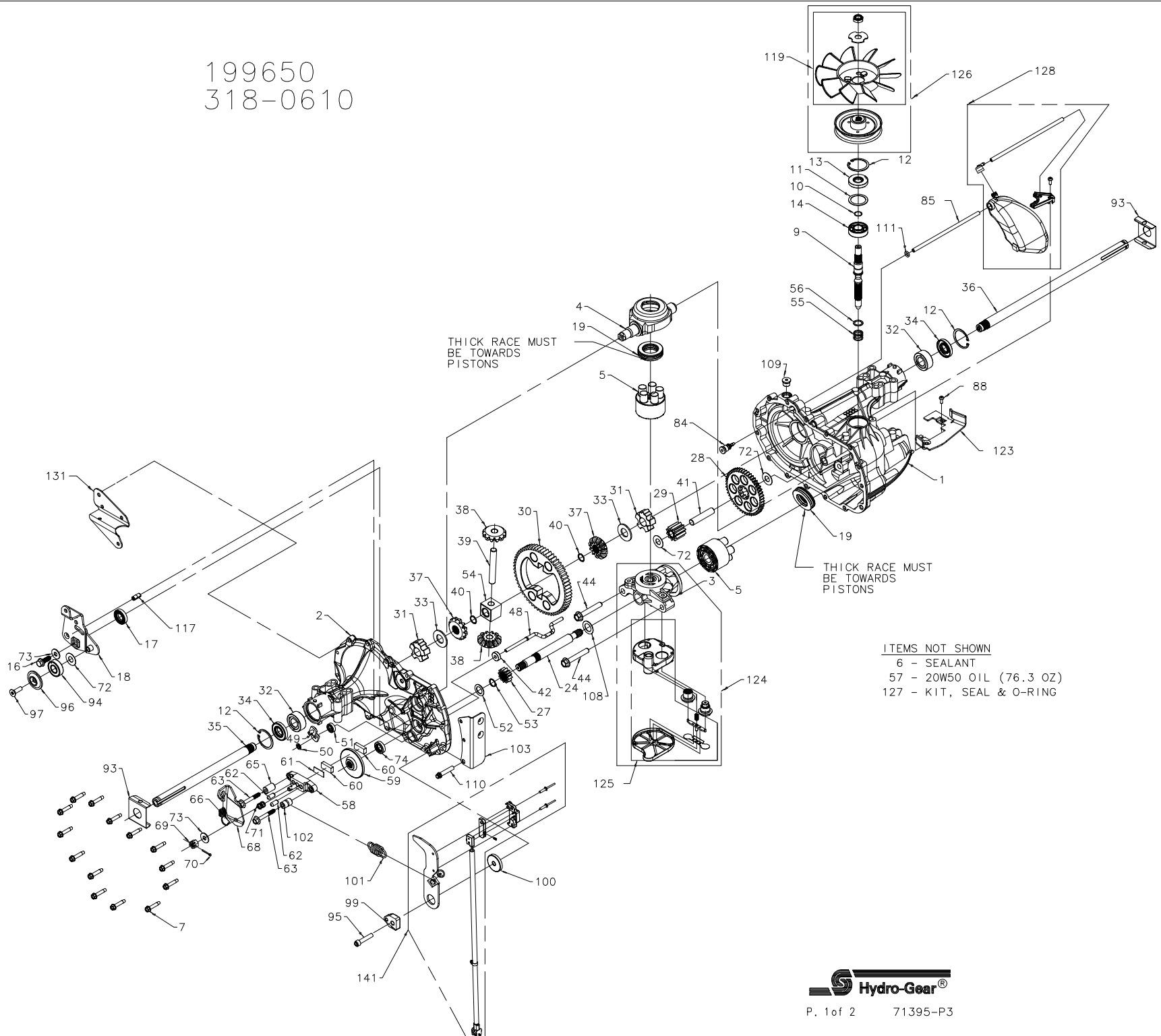

199650
318-0610

ITEM	PART NUMBER	QTY	DESCRIPTION
1	70467	1	ASSEMBLY, MAIN HOUSING
		1	HOUSING, MAIN
		1	BUSHING .865 X .985 X .790
		2	PIN, STANDARD HEADLESS
2	70483	1	ASSEMBLY, SIDE HOUSING
		1	HOUSING, SIDE
		1	BUSHING .865 X .985 X .790
		1	BUSHING, .624 X .719 X .562
3	70477	1	ASSEMBLY, CENTER SECTION
		1	CENTER SECTION (5-PISTON)
		1	BUSHING, .707 X .788 X .591
4	51048	1	TRUNNION, SWASHPLATE
5	70331	2	ASSEMBLY, BLOCK
		1	BLOCK, CYLINDER
		5	PISTON
		5	SPRING, COMPRESSION
		5	WASHER, THRUST
6	50928	10.1 OZ	SEALANT
7	51190	14	SCREW, HEX WASHER 1/4-20 X 1.25
9	51062	1	SHAFT, INPUT
10	2000022	1	RING, RETAINING
11	50951	1	WASHER, FLAT 1.23 X 1.57 X .04
12	50329	3	RING, RETAINING
13	51161	1	SEAL, LIP 17 X 40 X 7
14	50315	1	BEARING, BALL 17 X 40 X 12
16	51064	1	BOLT, HEX FLANGE 5/16-24 X .94 W/PATCH
17	51140	1	SEAL, LIP 18 X 32 X 7
18	51420	1	ARM, CONTROL
19	50551	2	BEARING, THRUST 30 X 52 X 13
24	50966	1	SHAFT, MOTOR
27	51767	1	GEAR, 12T PINION
28	51766	1	GEAR, 10T/49T
29	51043	1	GEAR, 10T JACKSHAFT
30	51044	1	GEAR, 60T BULL
31	51088	2	BUSHING, SLEEVE (INBOARD)
32	51089	2	BUSHING, SLEEVE .75 X 1.575 X .625
33	44875	2	WASHER, FLAT .77 X 1.5 X .10
34	51066	2	SEAL, LIP .750 X 1.577 X .250
35	51068	1	SHAFT, AXLE .75 x 11.39 (KEY, R.H.)
36	51067	1	SHAFT, AXLE .75 x 16.99 (KEY, L.H.)
37	51769	2	GEAR, MITER 12T (SPLINED)
38	51768	2	GEAR, MITER 12T (.50 ID)
39	50146	1	SHAFT, DIFFERENTIAL
40	44871	2	RING, SPIRAL RETAINING
41	51083	1	PIN, JACKSHAFT .50 X 2.43
42	51100	1	MAGNET, RING
44	50016	2	BOLT, HEX FLANGE 3/8-24 X 2.5
48	51098	1	ROD, ACTUATOR BYPASS
49	52223	1	ARM, BYPASS
50	51116	1	RING, RETAINING .250 EXTERNAL
51	51081	1	SEAL, LIP .250 X .750 X .250 TC

ITEM	PART NUMBER	QTY	DESCRIPTION
52	44371	1	WASHER, FLAT .63 X 1.00 X .05
53	44145	1	RING, RETAINING
54	51071	1	BUSHING, CENTER BLOCK
55	2003014	1	SPRING, BLOCK
56	2003017	1	WASHER, THRUST .59 X .79 X .04
57		76.3 OZ	OIL, 20W50
58	62589	1	KIT, BRAKE YOKE
		1	YOKE, BRAKE
		1	BOLT, SQ.HD. 5/16-24 RIBBED
59	51072	1	DISK, BRAKE
60	44132	2	PUCK, BRAKE
61	44134	1	PLATE, PUCK
62	44127	2	PIN, BRAKE ACTUATING
63	51146	2	BOLT, HEX HD 1/4-20 X 2 W/PATCH
65	23711	1	SPACER, .26 X .57 X .87
66	51529	1	SPRING, BRAKE ARM BIAS
68	52374	1	ARM, BRAKE
69	44142	1	NUT, CASTLE 5/16-24
70	44101	1	PIN, COTTER 3/32 X 3/4
71	50919	1	SPRING, COMPRESSION BRAKE ANTI-DRAG
72	50132	3	WASHER, FLAT .51 X 1.0 X .03
73	44130	2	WASHER, FLAT .34 X .88 X .06
74	70719	1	KIT, SEAL
		1	SEAL, LIP .625 X 1.0 X .25
		1	RING, RET - STAR WASHER
		1	BULLETIN, SHAFT SEAL
84	51143	1	FITTING, 5/16 SAE 5/32 TUBE
85	51147	1	HOSE, 7.56 IN EXPANSION TANK
88	50653	1	BOLT, SELF TAPPING 10-32 X .5
93	51118	2	SPRING CLIP, HOUSING THRUST (.75 IN AXLE)
94	44147	1	BEARING, BALL .62 X 1.38 X .44
95	50837	1	SCREW, SOCKET HD CAP 5/16-24 X 1.5
96	51200	1	SPACER, LOCATING
97	50870	1	SCREW, COUNTERSUNK 5/16-18 X 1.0
99	51097	1	PUCK, ADJUSTING
100	52493	1	WASHER, FLAT .32 X 1.60 X .24
101	51131	1	SPRING, EXTENSION DOUBLE LOOP
102	51123	1	SPACER, .26 X .56 X .87
103	52349	1	BRACKET, TORQUE
108	51069	1	WASHER, FLAT .71 X 1.16 X .04
109	9005110-5600	1	PLUG, 9/16-18 (METAL)
110	50868	1	SCREW, TORX HD 5/16-18 x 1.5
111	51144	1	O-RING, .299 x .505 x .103
117	51124	1	PIN, SPRING .304 x .75
119	70579	1	KIT,FAN
		1	NUT, HEX LOCK 1/2-20 W/NYLON INSERT
		1	WASHER, OD SLOTTED, .53 X 1.63 X .06
		1	FAN, 7.0 IN (10 BLADE)
123	52348	1	BRACKET, BELT KEEPER

ITEM	PART NUMBER	QTY	DESCRIPTION
124	71315	1	ASSEMBLY, CENTER SECTION, FILTER, BYPASS
		1	CENTER SECTION (5-PISTON)
		1	BASE, FILTER W/POPPET
		1	SHOCK VALVE ASSEMBLY, .027 BLEED, WASHER, 270 BAR
		1	CHECK PLUG ASSEMBLY, .027 BLEED, WASHER
		1	SPRING, BYPASS .50 IN
		1	ACTUATOR, BYPASS
		1	DEFLECTOR
		1	BOTTOM, FILTER
		1	BUSHING, .707 X .788 X .591
125	70756	1	ASSEMBLY, FILTER
		1	BASE, FILTER W/POPPET
		1	SPRING, BYPASS .50 IN
		1	ACTUATOR, BYPASS
		1	DEFLECTOR
		1	BOTTOM, FILTER
126	70460	1	KIT, FAN/PULLEY
		1	NUT, HEX LOCK 1/20-20 W/NYLON INSERT
		1	WASHER, OD SLOTTED, .53 X 1.63 X .06
		1	FAN, 7.0 IN (10 BLADE)
		1	PULLEY, 3.86 IN
127	70463	1	KIT, SEAL & O-RING
		1	SEAL, LIP 17 X 40 X 7
		1	SEAL, LIP 18 X 32 X 7
		2	SEAL, LIP .750 X 1.577 X .250
		1	SEAL, LIP .250 X .750 X .250 TC
		1	SEAL, LIP .625 X 1.0 X .25
		1	O-RING, .299 x .505 x .103
128	71376	1	KIT, EXPANSION TANK
		1	TANK, EXPANSION ASSEMBLY
		1	CAP, BARBED VENT
		1	BOLT, SELF TAPPING 10-32 X .5
		1	BRACKET, EXPANSION TANK
		1	HOSE, 7.56 IN EXPANSION TANK
131	51421	1	BRACKET, CRUISE/DAMPER
141	71401	1	ASSEMBLY, LT ROS
		1	ARM, RETURN
		1	SPRING GUIDE
		1	SWITCH, ROS
		1	ACTIVATOR, ROS SWITCH
		1	SPRING, ROS SWITCH
		1	RETAINER, ROS SWITCH
		2	RIVET, 5/32