

1001321
334-3000

THICK RACE MUST BE
TOWARD PISTON

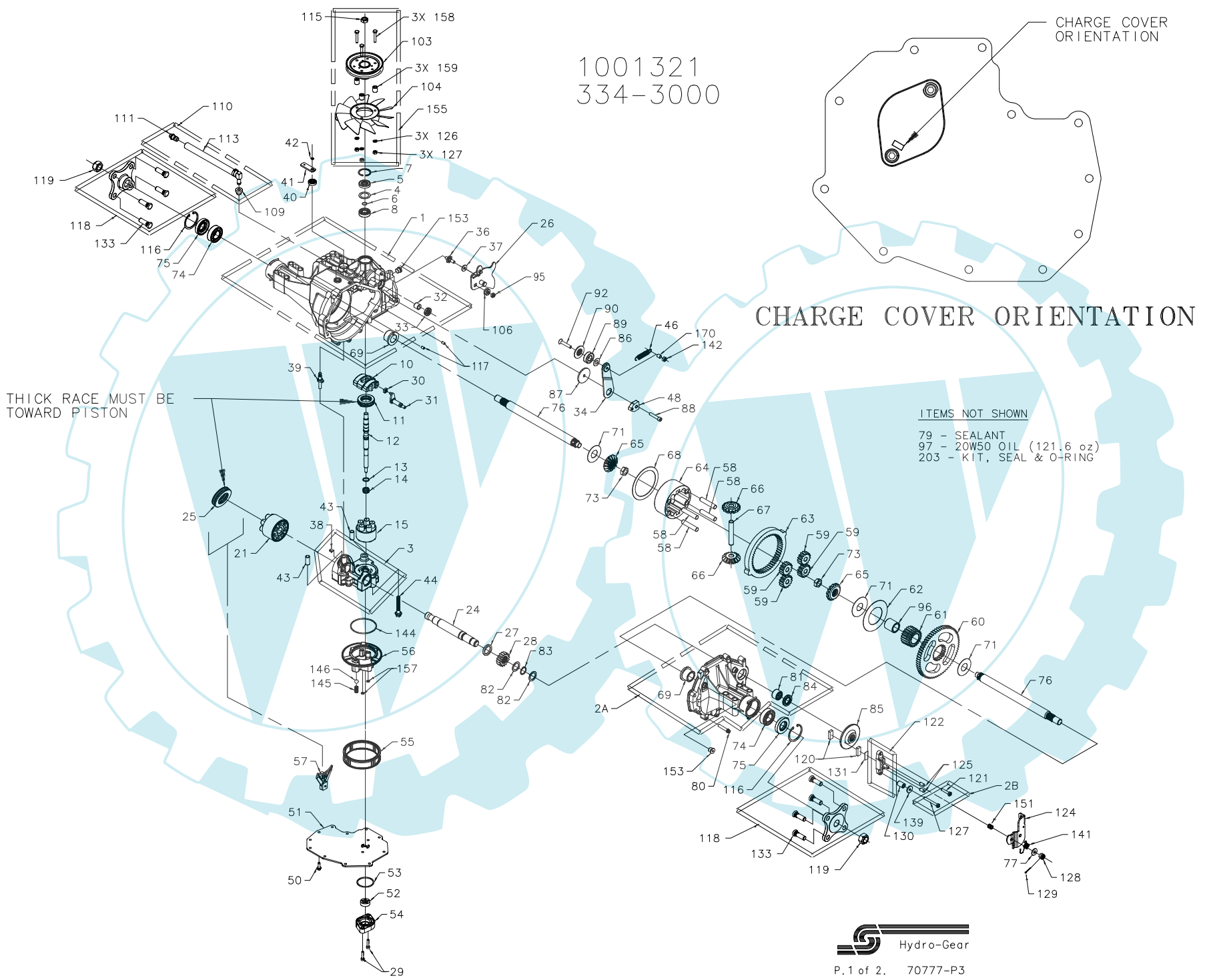

1001321
334-3000

ITEM#	PART #	QTY	DESCRIPTION	ITEM#	PART #	QTY	DESCRIPTION	ITEM#	PART #	QTY	DESCRIPTION
1	70433	1	ASSEMBLY, MAIN HOUSING	40	45074	1	SEAL, LIP 10 X 25 X 7	111	70109	1	ASSEMBLY, CAP-VENT
		1	HOUSING, MAIN, CASE DRAIN	41	44866	1	ARM, BYPASS			1	CAP, VENT
		1	SEAL, LIP 12 X 25 X 7	42	44870	1	RING, RETAINING			1	VENT, PLASTIC
		1	BEARING, FLANGE 1.0 X 1.376 X .99	43	50002	2	PIN, HOLLOW .39 X .50 X 1.12	113	70775	1	KIT, FITTING & HOSE ASS'Y
		1	BEARING, TRUNNION	44	50016	3	SCREW, HEX FLANGE 3/8-24 X 2.5			1	FITTING, 90° METAL VENT
		2	BEARING, CRADLE	46	51566	1	SPRING, 2.75 IN RETURN			1	HOSE, .5 X 8.75
2A	71120	1	ASSEMBLY, RIGHT HAND HOUSING	48	51097	1	PUCK, ADJUSTING			1	CLAMP, PINCH
		1	HOUSING, RIGHT HAND	50	50752	11	SCREW, HEX FLANGE 1/4-20 X .75	115	44133	1	NUT, HEX 1/2-20 W/ PATCH
		1	BEARING, FLANGE 1.0 X 1.376 X .99	51	50972	1	COVER, LOWER W/ 2 KIDNEYS	116	50859	2	RING, RETAINING
		1	BEARING, NEEDLE .875 X 1.125 X 1.5	52	50273	1	GEROTOR	117	9004800-2506	2	PIN, STANDARD HEADLESS
		1	SEAL, LIP .875 X 1.375 X .250	53	9004101-1340	1	O-RING, 1.862 X 2.068	118	70314	2	ASSEMBLY HUB
2B	71139	1	KIT, BRAKE BOLT	54	50260	1	HOUSING, CHARGE PUMP			4	HUB, 4 STUD (PAINTED)
		1	BOLT, HEX HD 1/4-20 X 1.25 W/PATCH	55	70538	1	KIT, FILTER			2	STUD, 1/2-20 X 1.55 (RIB NECK)
		1	BOLT, HEX HD 1/4-20 X 2.25 W/PATCH			2	GASKET, 4.24 X 4.40 X .10	119	50863	2	NUT, HEX LOCK 3/4-16
3	70683	1	ASSEMBLY, CENTER SECTION			1	FILTER, STD CHARGE	120	44132	2	PUCK, BRAKE
		1	CENTER SECTION	56	51156	1	MANIFOLD, CHARGE	121	51927	1	BOLT, HEX HD 1/4-20 X 1.25 W/PATCH
		1	BEARING, JOURNAL .50 X .59 X .50	57	50796	1	RETAINER, MOTOR BEARING	122	70633	1	ASSEMBLY, BRAKE YOKE
		1	BEARING, .90 X 1.0 X .75	58	50776	4	PIN, CARRIER	124	50916	1	ARM, BRAKE
		1	PLATE, BYPASS	59	50763	4	GEAR, 15T PLANET	125	44127	2	PIN, BRAKE ACTUATING
		2	CHECK PLUG ASSEMBLY, .027 BLEED	60	50646	1	GEAR, 67T SPUR	126	43177	3	WASHER, LOCK .489 X .258 X .062
4	2003018	1	SPACER, .98 X 1.37 X .04	61	50645	1	GEAR, 21T SUN	127	43178	3	NUT, HEX 1/4-20
5	9008000-0128	1	SEAL, LIP 15 X 35 X 7	62	50769	1	WASHER, THRUST 2.32 X 4.10 X .05	128	44142	1	NUT, CASTLE 5/16-24
6	2003016	1	RING, RETAINING	63	50764	1	GEAR, 51T RING	129	44101	1	PIN, COTTER 3/32 X 3/4
7	2003052	1	RING, RETAINING	64	50765	1	CARRIER, PLANETARY	130	23711	1	SPACER, .26 X .57 X .87
8	2003043	1	BEARING, BALL .59 X 1.38 X .43	65	50647	2	GEAR, 14T MITER (SPLINED)	131	44134	1	PLATE, PUCK
10	2003087	1	SWASHPLATE, VARIABLE	66	50648	2	GEAR, 14T MITER (UNSPLINED)	132	51928	1	BOLT, HEX HD 1/4-20 X 2.25 W/PATCH
11	50551	1	BEARING, THRUST 30 X 52 X 13	67	50766	1	SHAFT, DIFFERENTIAL	133	44431	8	STUD, 1/2-20 X 1.55 (RIB NECK)
12	50795	1	SHAFT, INPUT (STD CHARGE)	68	50767	1	WASHER, THRUST 3.46 X 4.39 X .05	139	44278	1	WASHER, .27 X .88 X .12
13	2003017	1	WASHER, THRUST .59 X .79 X .04	69	50768	2	BEARING, FLANGE 1.0 X 1.376 X .99	141	50884	1	SPRING, BRAKE ARM BIAS
14	2003014	1	SPRING, BLOCK	71	50788	3	WASHER, 1.0 X 2.25 X .04	142	43064	1	NUT, HEX LOCK 5/16-18
15	70331	1	ASSEMBLY, BLOCK	74	50771	2	BEARING, BALL 25.4 X 52 X 15	144	50974	1	O-RING, 2.987 X 3.09
		1	BLOCK, CYLINDER	73	50791	2	NUT, HEX 5/8-18 W/ PATCH	145	51157	1	SPRING, RELIEF
		5	PISTON	74	50771	2	BEARING, BALL 25.4 X 52 X 15	146	9001214-4400	1	BALL, 7/16 IN
		5	SPRING, COMPRESSION	75	50772	2	SEAL, LIP 1.0 X 2.049 X .375	151	50919	1	SPRING, COMP. BRAKE ANTI-DRAW
		5	WASHER, THRUST	76	50825	2	SHAFT, AXLE 1.0 X 13.84 (30° SPLINED)	153	9005110-5600	2	PLUG, 9/16-18 (METAL)
21	70082	1	ASSEMBLY, BLOCK	77	44130	1	WASHER, .34 X .88 X .06	155	70243	1	KIT, FAN/PULLEY
		1	BLOCK, CYLINDER	79	50928	10	SEALANT			1	NUT, HEX 1/2-20 W/ PATCH
		7	PISTON	80	50868	9	SCREW, TORX HD 5/16-18 X 1.5			3	BOLT, 1/4-20 X 1.5 W/ PATCH
		7	SPRING, COMPRESSION	81	44752	1	BEARING, NEEDLE .875 X 1.125 X 1.5			1	PULLEY, 4.5 IN
		7	WASHER, THRUST	82	50777	2	WASHER, FLAT .88 X 1.25 X .04			1	SPACER, .571 X .260 X .618
24	50662	1	SHAFT, MOTOR	83	50775	1	RING, RETAINING			3	FAN, 7.0 IN (10 BLADE)
25	50552	1	BEARING, THRUST 42 X 68 X 16	84	50773	1	SEAL, LIP .875 X 1.375 X .250			3	WASHER, LOCK .489 X .258 X .062
26	51564	1	ARM, CONTROL	85	50779	1	DISK, BRAKE			3	NUT, HEX 1/4-20
27	50774	1	SPACER, 1.03 X 1.38 X .184	86	50132	1	WASHER, .51 X 1.0 X .03	157	50977	2	O-RING, .239 X .379
28	50661	1	GEAR, 16T PINION	87	50836	1	SPACER, .32 X 1.96 X .15	170	51568	1	SPACER, .330 X .375 X .42
29	50975	2	SCREW, CAP M6 X 1 X 25	88	50837	1	SCREW, SOCKET HD CAP 5/16-24 X 1.5	203	70492	1	KIT, SEAL & O-RING
30	2000015	1	GUIDE, SLOT	89	44147	1	BEARING, BALL .62 X 1.38 X .44			1	SEAL, LIP 15 X 35 X 7
31	50807	1	ARM, TRUNNION TAPERED SQUARE	90	51200	1	SPACER, LOCATING			1	SEAL, LIP 12 X 25 X 7
32	2003009	1	BEARING, TRUNNION	92	51567	1	SCREW, COUNTERSUNK 5/16-18 X 1.75			1	SEAL, LIP 10 X 25 X 7
33	9008000-0126	1	SEAL, LIP 12 X 25 X 7	95	50108	1	NUT, HEX LOCK 5/16-24			1	O-RING, 1.862 X 2.068
34	51565	1	ARM, RETURN	96	50866	1	BUSHING, SLEEVE 1.0 X 1.3 X 1.34			2	SEAL, LIP 1.0 X 2.049 X .375
36	50426	1	STUD, SHORT 5/16-24	97	50302	121	OIL, 20W50			1	SEAL, LIP .875 X 1.375 X .250
37	50281	1	PUCK, .798 X .319 X .097	103	50302	1	PULLEY, 4.5 IN			2	O-RING, .239 X .309
38	70680	1	KIT, BYPASS PLATE	104	50307	1	FAN, 7.0 IN (10 BLADE)			1	KIT, MANIFOLD O-RING
39	2003555	1	ACTUATOR, BYPASS	106	51604	1	SPACER, TRUNNION				
				109	50133	1	BUSHING, VENT (RUBBER)				
				110	70776	1	KIT, FITTING & HOSE ASS'Y & CAP-VENT				
						1	BUSHING, VENT (RUBBER)				
						1	FITTING, 90° METAL VENT				
						1	ASSEMBLY, CAP-VENT				
						1	HOSE, .5 X 8.75				
						1	CLAMP, PINCH				